

# SITE DEVELOPMENT PLANS

# JUNO DUNE WALKOVER

**SECTION 21, TOWNSHIP 41S., RANGE 43E.  
TOWN OF JUNO BEACH, FLORIDA**

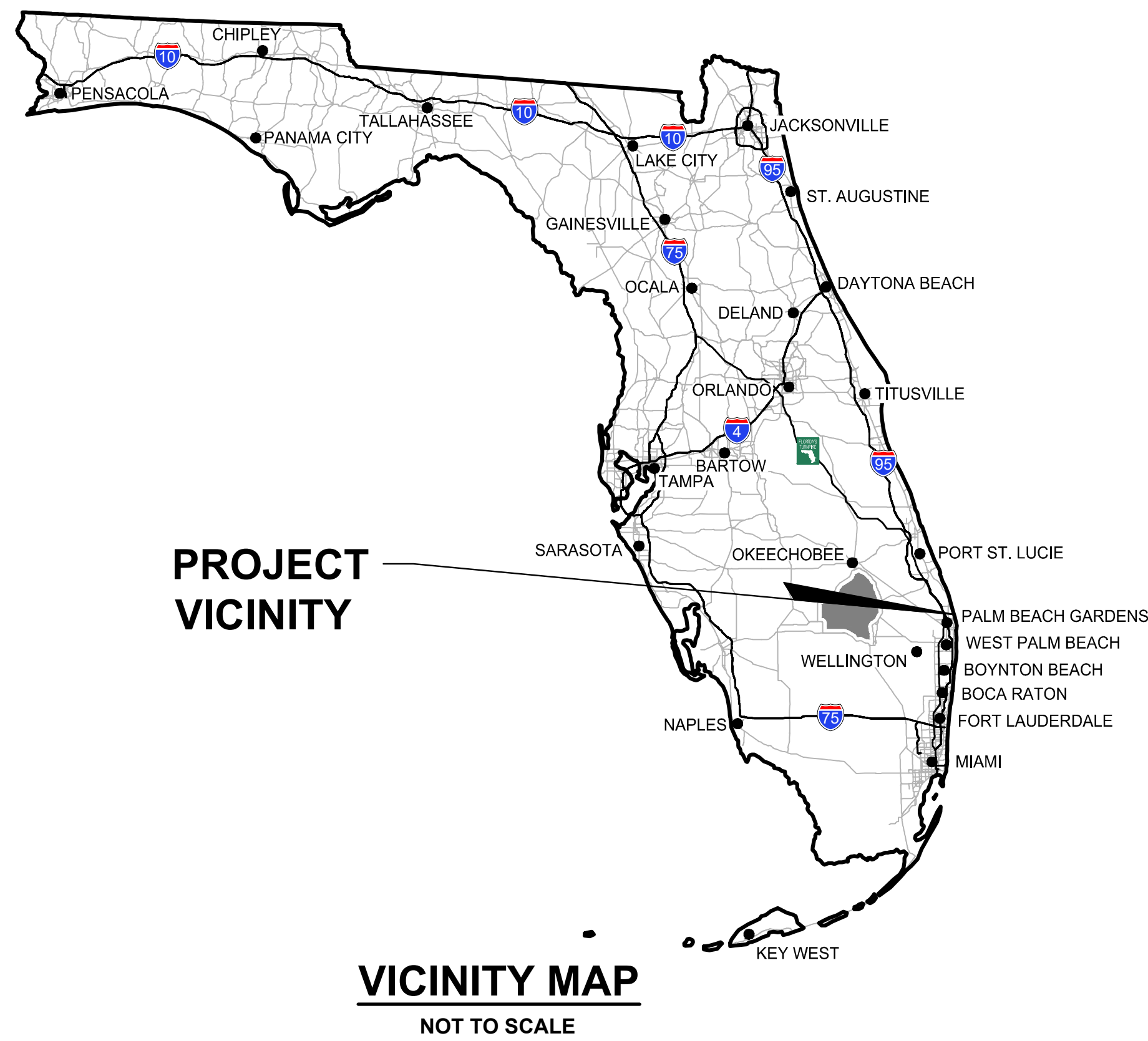

## INDEX OF SHEETS

<u>SHEET NO.:</u>	<u>DESCRIPTION:</u>
1	TITLE SHEET
2	DRAINAGE PLAN
3	LAND CLEARING AND EROSION CONTROL PLAN

## LOCATION MAP

NOT TO SCALE

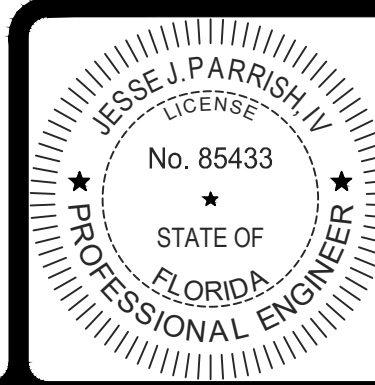

JESSE J. PARRISH, IV., P.E., STATE OF FLORIDA,  
PROFESSIONAL ENGINEER, LICENSE NO. 85433

THIS ITEM HAS BEEN ELECTRONICALLY SIGNED AND  
SEALED BY JESSE J. PARRISH, IV., P.E. ON  
8/5/2025 USING A SHA-1 AUTHENTICATION CODE.

PRINTED COPIES OF THIS DOCUMENT ARE NOT  
CONSIDERED SIGNED AND SEALED AND THE SHA-1  
AUTHENTICATION CODE MUST BE VERIFIED ON ANY  
ELECTRONIC COPIES.



**JUNO DUNE WALKOVER**  
SECTION 28, TOWNSHIP 41S., RANGE 43E.  
TOWN OF JUNO BEACH, FLORIDA  
**TITLE SHEET**

DESIGN J.P.	DRAWN D.B.	CHECKED	APPROVED	DATE	JOB NO. 24-169	DRAWING NO. 24169D01	SHEET 1	OF 3
----------------	---------------	---------	----------	------	-------------------	-------------------------	------------	---------







SILT FENCE NOTES:

- 1.) THE HEIGHT OF A SILT FENCE SHALL NOT EXCEED 36 INCHES (90 CM).
- 2.) THE FILTER FABRIC SHALL BE PURCHASED IN A CONTINUOUS ROLL CUT TO THE LENGTH OF THE BARRIER TO AVOID THE USE OF JOINTS.
- 3.) POSTS SHALL BE SPACED A MAXIMUM OF 10 FEET (3 M) APART AT THE BARRIER LOCATION AND DRIVEN SECURELY INTO THE GROUND A MINIMUM OF 12 INCHES (30 CM). WHEN EXTRA STRENGTH FABRIC IS USED WITHOUT THE WIRE SUPPORT FENCE, POST SPACING SHALL NOT EXCEED 6 FEET (1.8 M).
- 4.) A TRENCH SHALL BE EXCAVATED APPROXIMATELY 4 INCHES (10 CM) WIDE AND 4 INCHES (10 CM) DEEP ALONG THE LINE OF POSTS AND UPSLOPE FROM THE BARRIER.
- 5.) WHEN STANDARD STRENGTH FILTER FABRIC IS USED, A WIRE MESH SUPPORT FENCE SHALL BE FASTENED SECURELY TO THE UPSLOPE SIDE OF THE POSTS USING HEAVY DUTY WIRE STAPLES AT LEAST 1 INCH (25 MM) LONG, TIE WIRES, OR HOG RINGS. THE WIRE SHALL EXTEND INTO THE TRENCH A MINIMUM OF 2 INCHES (5 CM) AND SHALL NOT EXTEND MORE THAN 36 INCHES (90 CM) ABOVE THE ORIGINAL GROUND SURFACE.
- 6.) THE STANDARD STRENGTH FILTER FABRIC SHALL BE STAPLED OR WIRED TO THE FENCE, AND 8 INCHES (20 CM) OF THE FABRIC SHALL BE EXTENDED INTO THE TRENCH. THE FABRIC SHALL NOT EXTEND MORE THAN 36 INCHES (90 CM) ABOVE THE ORIGINAL GROUND SURFACE.
- 7.) THE TRENCH SHALL BE BACKFILLED AND THE SOIL COMPACTED OVER THE FILTER FABRIC.
- 8.) PROPOSED SILT FENCE (REQUIRED DURING CONSTRUCTION PER N.P.D.E.S./F.D.E.P. REGULATIONS) TO BE PLACED AS NECESSARY BY CONTRACTOR BASED ON FIELD CONDITIONS AND CONSTRUCTION SEQUENCING.

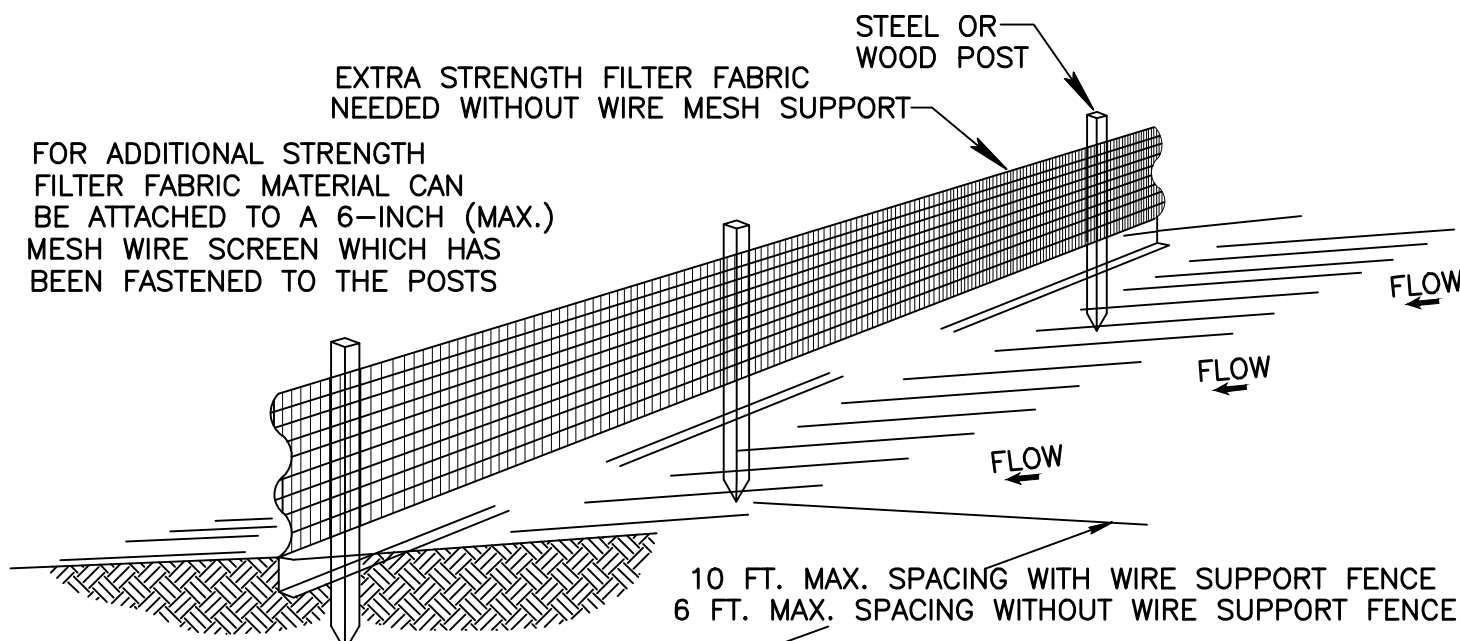

SILT FENCE INSTALLATION DETAIL  
NOT TO SCALE.

NOTES:

- PROPERTY CORNERS SHALL BE LOCATED BY A LICENSED LAND SURVEYOR AND CLEARLY MARKED IN THE FIELD PRIOR TO THE ENGINEERING DEPARTMENTS PRE-CONSTRUCTION MEETING FOR SITE DEVELOPMENT.
- AUTHORIZATION TO INSTALL EROSION CONTROL DEVICES AND PRESERVE BARRICADES WILL BE GRANTED AT THE PRE-CONSTRUCTION MEETING. THIS AUTHORIZATION SHALL BE POSTED ON THE SITE.
- NO ADDITIONAL LAND CLEARING SHALL COMMENCE UNTIL A SATISFACTORY INSPECTION OF THE REQUIRED EROSION CONTROL BARRICADES HAS BEEN OBTAINED.
- ALL CONSTRUCTION BARRICADES AND SILT FENCES WILL REMAIN IN PLACE AND BE MONITORED FOR COMPLIANCE BY THE PERMIT HOLDER DURING THE PERMITTED DEVELOPMENT ACTIVITIES OR AS REQUIRED BY THE TOWN OF JUNO BEACH.
- PRIOR TO SCHEDULING A FINAL ENVIRONMENTAL INSPECTION FOR THE INFRASTRUCTURE, ALL BARRICADES AND EROSION CONTROL DEVICES SHALL BE REMOVED AND DISPOSED OF BY THE CONTRACTOR.

POLLUTION PREVENTION NOTES:

- 1.) THIS PLAN SHOULD BE USED AS A GUIDE, IT IS THE CONTRACTORS RESPONSIBILITY TO COMPLY WITH ALL LOCAL, STATE AND FEDERAL POLLUTION PREVENTION REQUIREMENTS.
- 2.) CONTRACTOR IS RESPONSIBLE TO ENSURE THAT NO DIRT BE TRACKED OFF-SITE OR LEAVES THE SITE BY WIND, RUNOFF, OR OTHER MEANS.
- 3.) CONTRACTOR SHALL BE RESPONSIBLE FOR ALL N.P.D.E.S. REQUIREMENTS AS DIRECTED BY TOWN OF JUNO BEACH.
- 4.) POLLUTION PREVENTION MEASURES SHALL CONSIST OF, BUT NOT LIMITED TO, THE FOLLOWING:
- A. CONSTRUCT EROSION CONTROL FENCE AND/OR TURBIDITY SCREENS ALONG PROPERTY LINES AS NEEDED.
- B. NO AREA SHALL BE LEFT BARREN OR SUBJECT TO EROSION DURING CONSTRUCTION.
- C. TURBIDITY BARRIERS TO BE UTILIZED AT PROJECT OUTFALL.
- D. OTHER MEASURES AS DIRECTED BY THE ENGINEER OR THE TOWN OF JUNO BEACH.



LOCATION MAP  
NOT TO SCALE

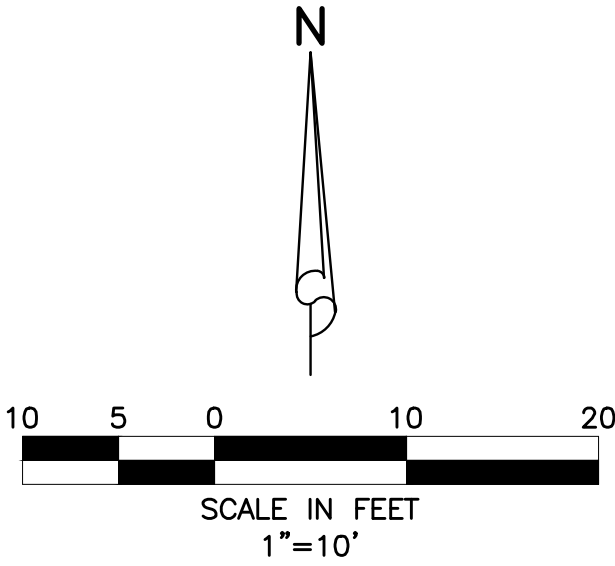

LEGEND

- SILT FENCE
- ▨ LAND TO BE CLEARED

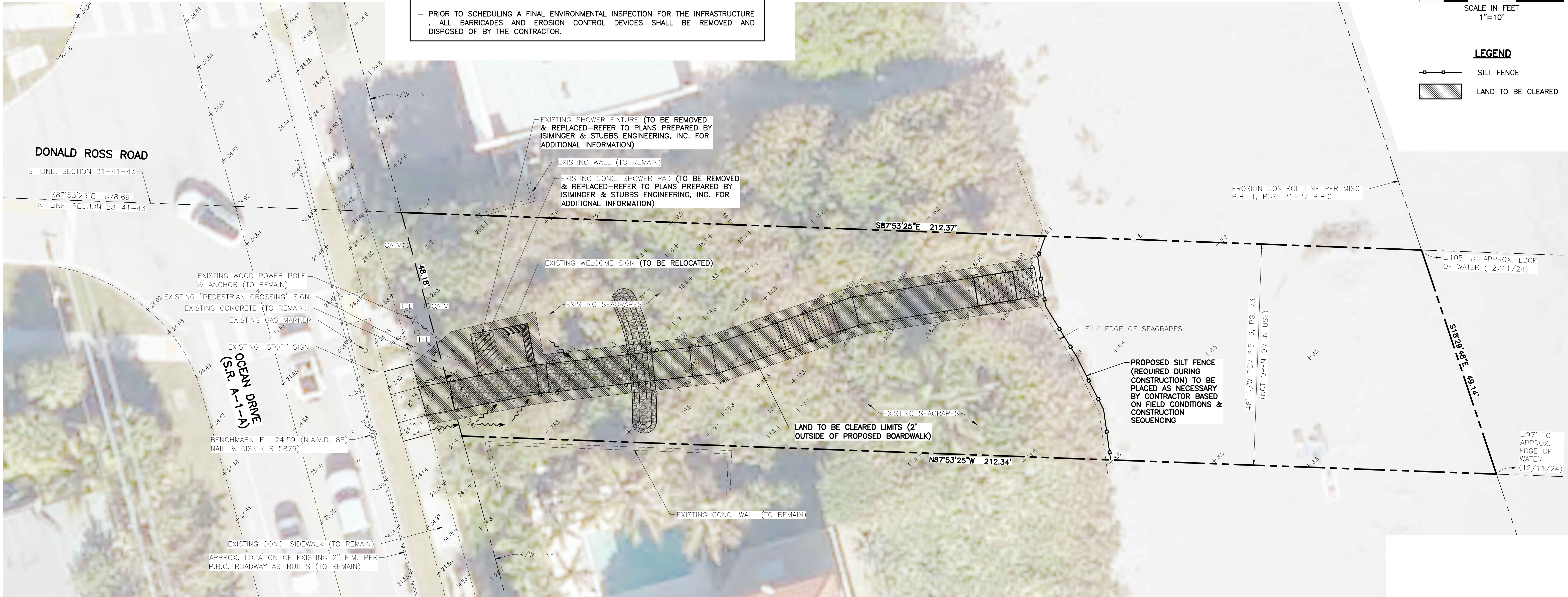

48 HOURS BEFORE DIGGING  
BROWARD • PALM BEACH • INDIAN RIVER  
ST. LUCIE • MARTIN COUNTIES  
1-800-432-4770  
SUNSHINE STATE 1 CALL  
UNDERGROUND UTILITIES  
NOTIFICATION CENTER

NOTE: ALL ELEVATIONS SHOWN HEREON ARE RELATIVE TO THE NORTH AMERICAN VERTICAL DATUM (N.A.V.D.) OF 1988 BASED ON A SURVEY PREPARED BY R.L. VAUGHT & ASSOC., INC. (772) 546-8086.

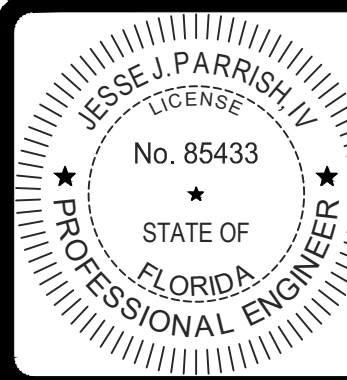

JESSE J. PARRISH, IV., P.E., STATE OF FLORIDA, PROFESSIONAL ENGINEER, LICENSE NO. 85433

THIS ITEM HAS BEEN ELECTRONICALLY SIGNED AND SEALED BY JESSE J. PARRISH, IV., P.E. ON 8/5/2025 USING A SHA-1 AUTHENTICATION CODE.

PRINTED COPIES OF THIS DOCUMENT ARE NOT CONSIDERED SIGNED AND SEALED AND THE SHA-1 AUTHENTICATION CODE MUST BE VERIFIED ON ANY ELECTRONIC COPIES.

- 3.) REVISED & REMOVED EROSION CONTROL NOTES PER TOWN OF JUNO BEACH, 08/05/25 D.B.
- 2.) REVISED EROSION CONTROL NOTES PER TOWN OF JUNO BEACH, 05/13/25 C.O.
- 1.) REVISED SILT FENCE PLACEMENT LIMITS PER TOWN OF JUNO BEACH, 05/05/25 D.B.



DESIGN	DRAWN	CHECKED	APPROVED	DATE
J.P.	D.B.			

JUNO DUNE WALKOVER  
SECTION 28, TOWNSHIP 41S., RANGE 43E.  
TOWN OF JUNO BEACH, FLORIDA  
LAND CLEARING AND  
EROSION CONTROL PLAN

JOB NO.	DRAWING NO.	SHEET	OF
24-169	24169D03	3	3