

WIND LOAD INFO:  
V<sub>asd</sub> = 124 mph  
V<sub>ult</sub> = 160 mph (3 sec. GUST)  
RISK CATEGORY I  
Exposure D

LOADS:  
THE DUNE WALKOVER STRUCTURE HAS BEEN DESIGNED FOR A VERTICAL LIVE LOAD OF 100 PSF, DEAD LOADS ASSOCIATED WITH THE STRUCTURE ITSELF, AND WIND LOADS PER CODE (UNDER CURRENT GRADE CONDITIONS). THE STRUCTURE HAS NOT BEEN DESIGNED FOR SCOUR, OR HYDRODYNAMIC LOADS (INCLUDING BUT NOT LIMITED TO WAVE LOADS, CURRENT LOADS, ETC.).

ENGINEER MAKES NO WARRANTY OR CERTIFICATION REGARDING EXISTING STRUCTURES (INCLUDING EXISTING PILES) ONSITE.

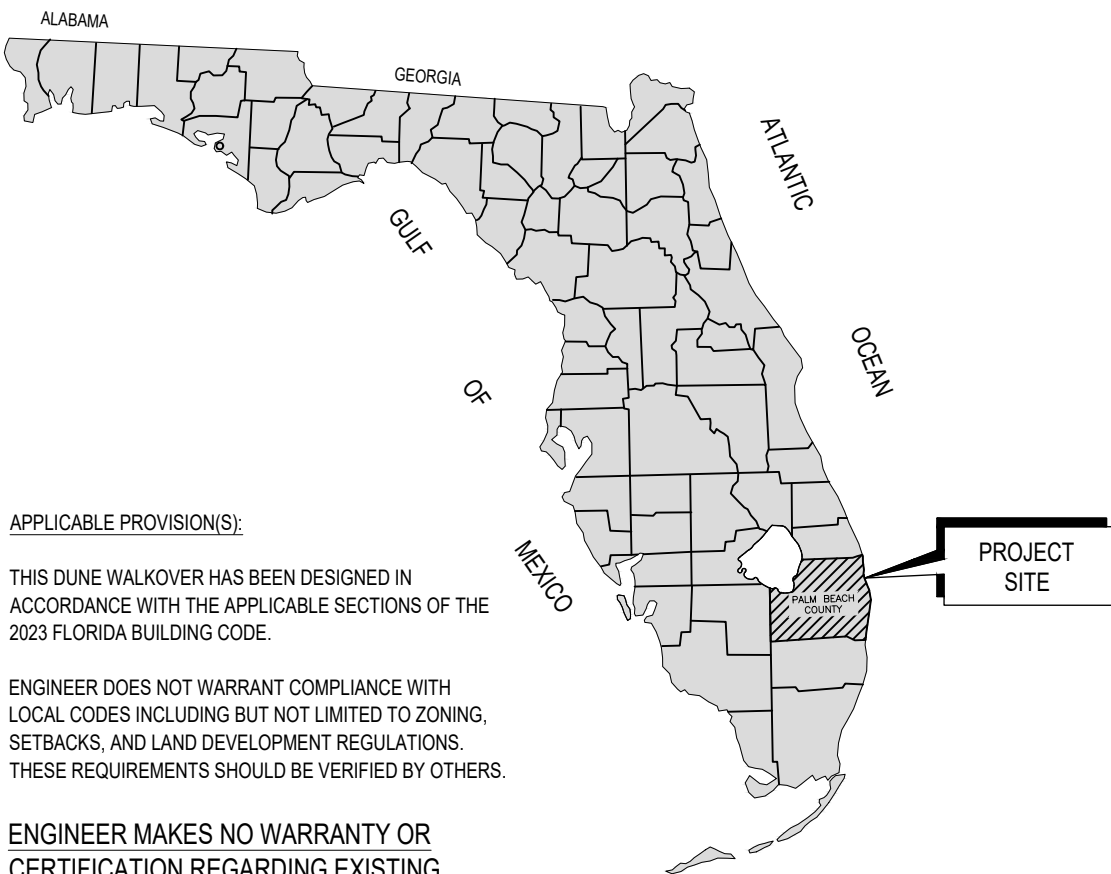

APPLICABLE PROVISION(S):

THIS DUNE WALKOVER HAS BEEN DESIGNED IN ACCORDANCE WITH THE APPLICABLE SECTIONS OF THE 2023 FLORIDA BUILDING CODE.

ENGINEER DOES NOT WARRANT COMPLIANCE WITH LOCAL CODES INCLUDING BUT NOT LIMITED TO ZONING, SETBACKS, AND LAND DEVELOPMENT REGULATIONS. THESE REQUIREMENTS SHOULD BE VERIFIED BY OTHERS.

ENGINEER MAKES NO WARRANTY OR CERTIFICATION REGARDING EXISTING STRUCTURES ONSITE.

NOTE:  
THESE PLANS DO NOT INCLUDE ALL TECHNICAL SPECIFICATIONS REQUIRED FOR CONSTRUCTION.

ATLANTIC OCEAN FRONTAGE  
DONALD ROSS ROAD AND OCEAN DRIVE  
JUNO BEACH  
PALM BEACH COUNTY, FLORIDA  
CLIENT:  
TOWN OF JUNO BEACH

AUGUST 2025



This item has been digitally signed and sealed by Mark A. Powell, P.E. on the date adjacent to the seal. Printed copies of this document are not considered signed and sealed and the signature must be verified on any electronic copies.

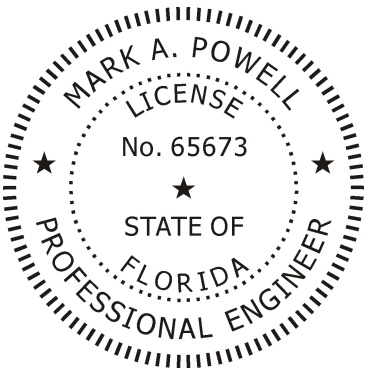

ENGINEER IS NOT RESPONSIBLE FOR ON-SITE OR OFF-SITE DAMAGES DUE TO VIBRATIONS.



INDEX TO DRAWINGS

SHEET NUMBER	TITLE
1	VICINITY MAP & TITLE SHEET
2	EXISTING SITE PLAN
3	OVERALL SITE PLAN
4	PILE LAYOUT
5	FRAMING PLAN
6	ELEVATION VIEW
7	SECTION VIEWS
8	BENCH DETAIL
9	PLATFORM FRAMING DETAIL
10	STAIR DETAIL

VICINITY MAP & TITLE SHEET

 <b>ISIMINGER &amp; STUBBS ENGINEERING, INC.</b> COASTAL • ENVIRONMENTAL • MARINE REGISTRATION NUMBER: 8114 P.O. BOX 14702 • NORTH PALM BEACH, FL 33408 • 561-881-0003							
DUNE WALKOVER CONSTRUCTION ATLANTIC OCEAN FRONTAGE DONALD ROSS ROAD AND OCEAN DRIVE JUNO BEACH, PALM BEACH COUNTY, FL CLIENT: TOWN OF JUNO BEACH							
DATE	8/25	DRAWN	IBN	CHKD	MAP	APPRVD	MAP
DWG NO.	24147G1					SHEET	
COMPUTER FILE NO.	24147G					OF 10	
							<b>1</b>

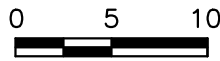
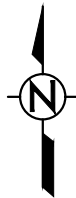

SCALE IN FEET  
1"= 10'

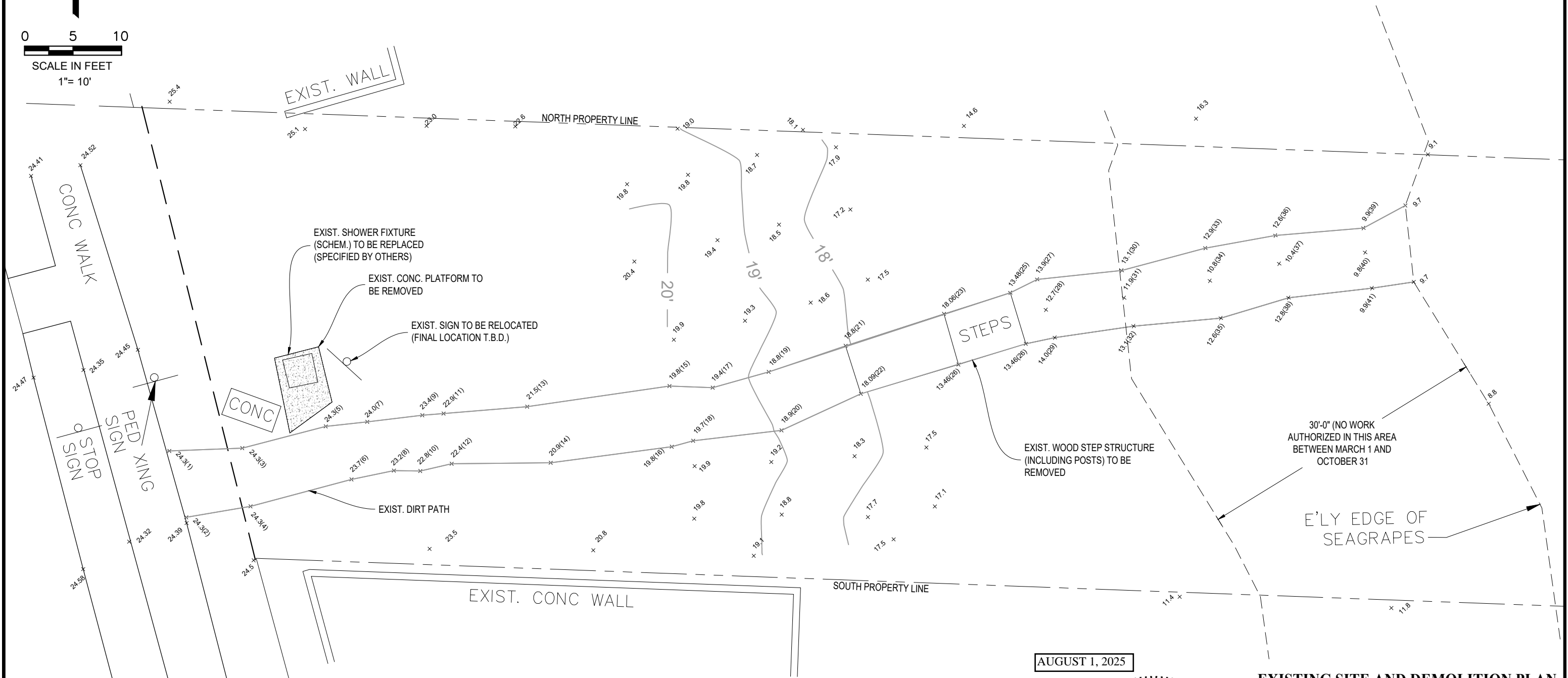

GENERAL NOTES:

- DATUM IS NAVD.
- EXISTING LOCATIONS AND ELEVATIONS ARE APPROXIMATE, BASED ON SURVEY BY R.L. VAUGHT & ASSOCIATES, INC., DATED 12/18/2024.

This item has been digitally signed and sealed by Mark A. Powell, P.E. on the date adjacent to the seal. Printed copies of this document are not considered signed and sealed and the signature must be verified on any electronic copies.

AUGUST 1, 2025

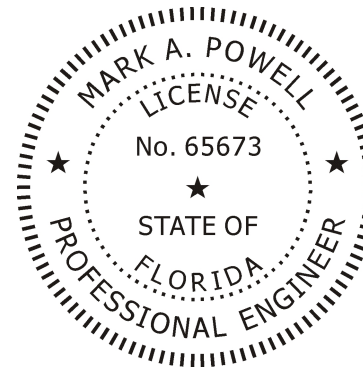

EXISTING SITE AND DEMOLITION PLAN



**ISIMINGER & STUBBS  
ENGINEERING, INC.**

COASTAL • ENVIRONMENTAL • MARINE

REGISTRATION NUMBER: 8114  
P.O. BOX 14702 - NORTH PALM BEACH, FL 33408 - 561-881-0003

DUNE WALKOVER CONSTRUCTION  
ATLANTIC OCEAN FRONTAGE  
DONALD ROSS ROAD AND OCEAN DRIVE  
JUNO BEACH, PALM BEACH COUNTY, FL  
CLIENT: TOWN OF JUNO BEACH

DATE	8/25	DRAWN	IBN	CHKD	MAP	APPRVD	MAP
DWG NO.	24147G2						SHEET
COMPUTER FILE NO.	24147G						OF 10

2

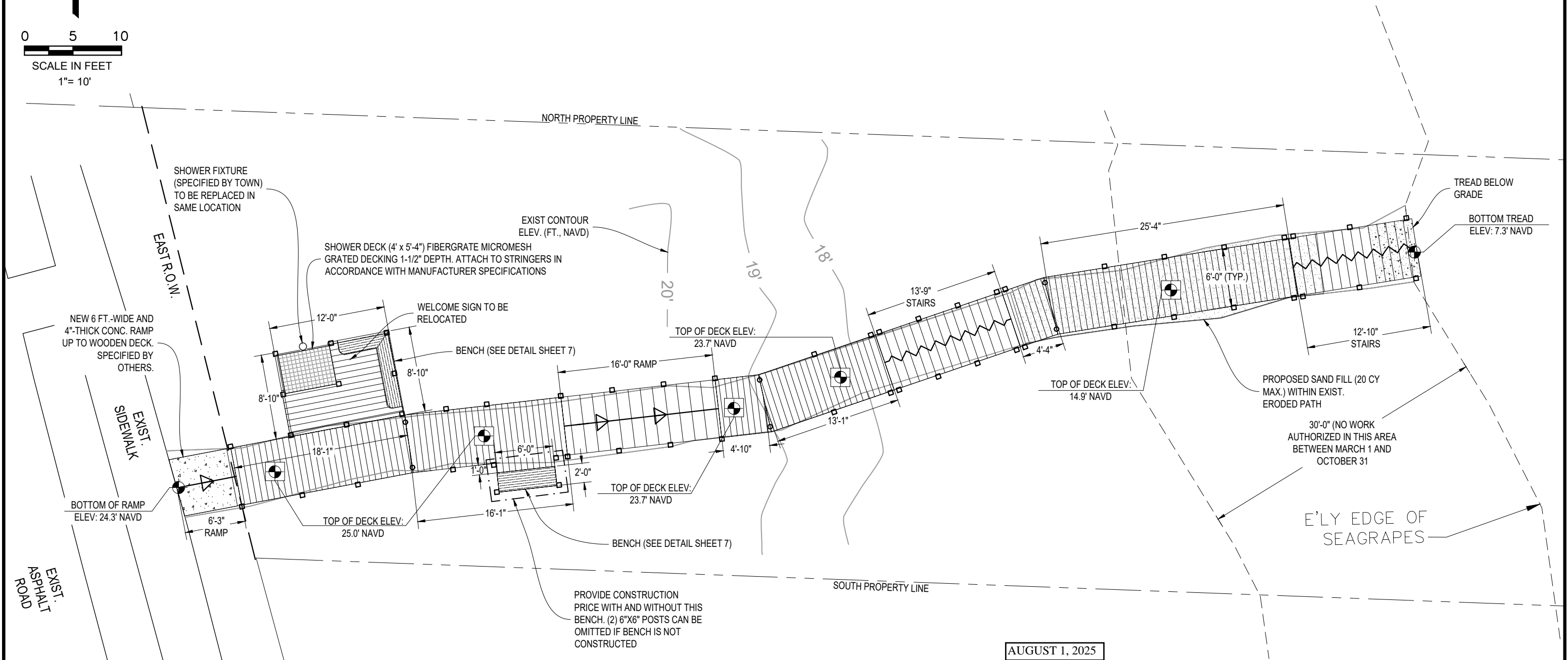
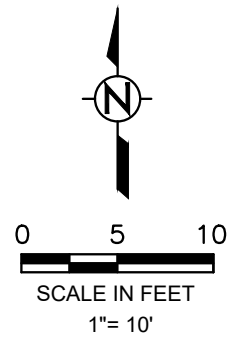

- GENERAL NOTES:
- DATUM IS NAVD.
  - EXISTING LOCATIONS AND ELEVATIONS ARE APPROXIMATE, BASED ON SURVEY BY R.L. VAUGHT & ASSOCIATES, INC., DATED 12/18/2024.

This item has been digitally signed and sealed by Mark A. Powell, P.E. on the date adjacent to the seal. Printed copies of this document are not considered signed and sealed and the signature must be verified on any electronic copies.

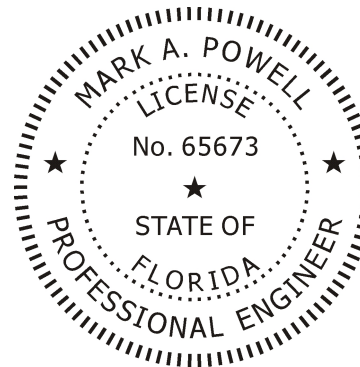

**OVERALL SITE PLAN**

**ISIMINGER & STUBBS ENGINEERING, INC.**  
COASTAL • ENVIRONMENTAL • MARINE  
REGISTRATION NUMBER: 8114  
P.O. BOX 14702 - NORTH PALM BEACH, FL 33408 - 561-881-0003

**DUNE WALKOVER CONSTRUCTION**  
ATLANTIC OCEAN FRONTAGE  
DONALD ROSS ROAD AND OCEAN DRIVE  
JUNO BEACH, PALM BEACH COUNTY, FL  
CLIENT: TOWN OF JUNO BEACH

DATE	8/25	DRAWN	IBN	CHKD	MAP	APPRVD	MAP
DWG NO.	24147G3						SHEET
COMPUTER FILE NO.	24147G						OF 10

**3**



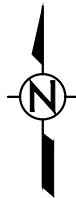

0 5 10  
SCALE IN FEET  
1"= 10'

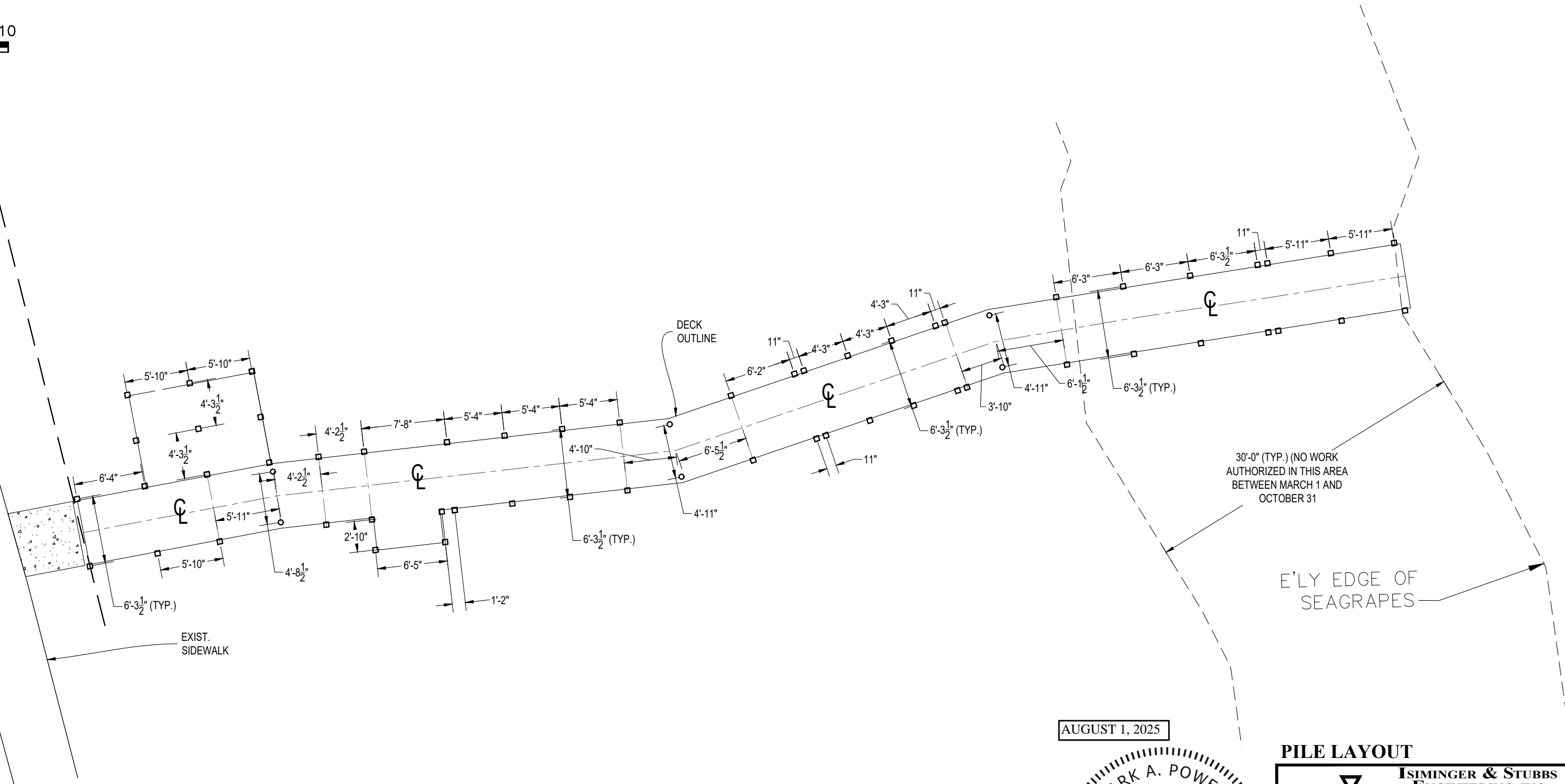

GENERAL NOTES:

- DATUM IS NAVD.
- EXISTING LOCATIONS AND ELEVATIONS ARE APPROXIMATE, BASED ON SURVEY BY R.L. VAUGHT & ASSOCIATES, INC., DATED 12/18/2024.

This item has been digitally signed and sealed by Mark A. Powell, P.E. on the date adjacent to the seal. Printed copies of this document are not considered signed and sealed and the signature must be verified on any electronic copies.

AUGUST 1, 2025

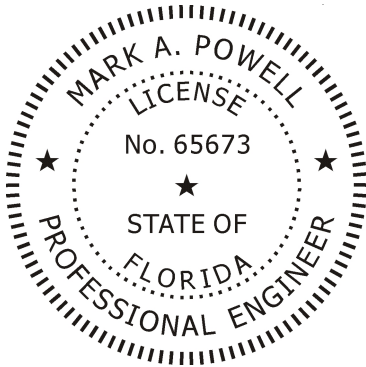

PILE LAYOUT

**ISIMINGER & STUBBS  
ENGINEERING, INC.**  
COASTAL • ENVIRONMENTAL • MARINE  
REGISTRATION NUMBER: 8114  
P.O. BOX 14702 - NORTH PALM BEACH, FL 33408 - 561-881-0003

**DUNE WALKOVER CONSTRUCTION**  
**ATLANTIC OCEAN FRONTAGE**  
**DONALD ROSS ROAD AND OCEAN DRIVE**  
**JUNO BEACH, PALM BEACH COUNTY, FL**  
**CLIENT: TOWN OF JUNO BEACH**

DATE	8/25	DRAWN	IBN	CHKD	MAP	APPRVD	MAP
DWG NO.	24147G4						SHEET OF 10
COMPUTER FILE NO.	24147G						

4

INFLECTION POINT  
FRAMING DETAIL (TYP.)

0 1 2  
SCALE IN FEET  
1"=2'

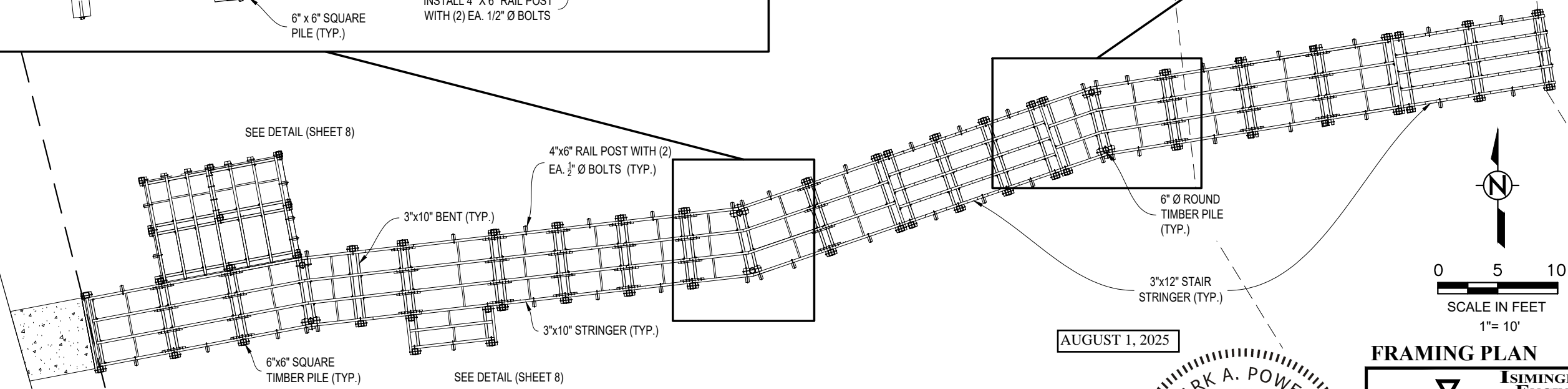
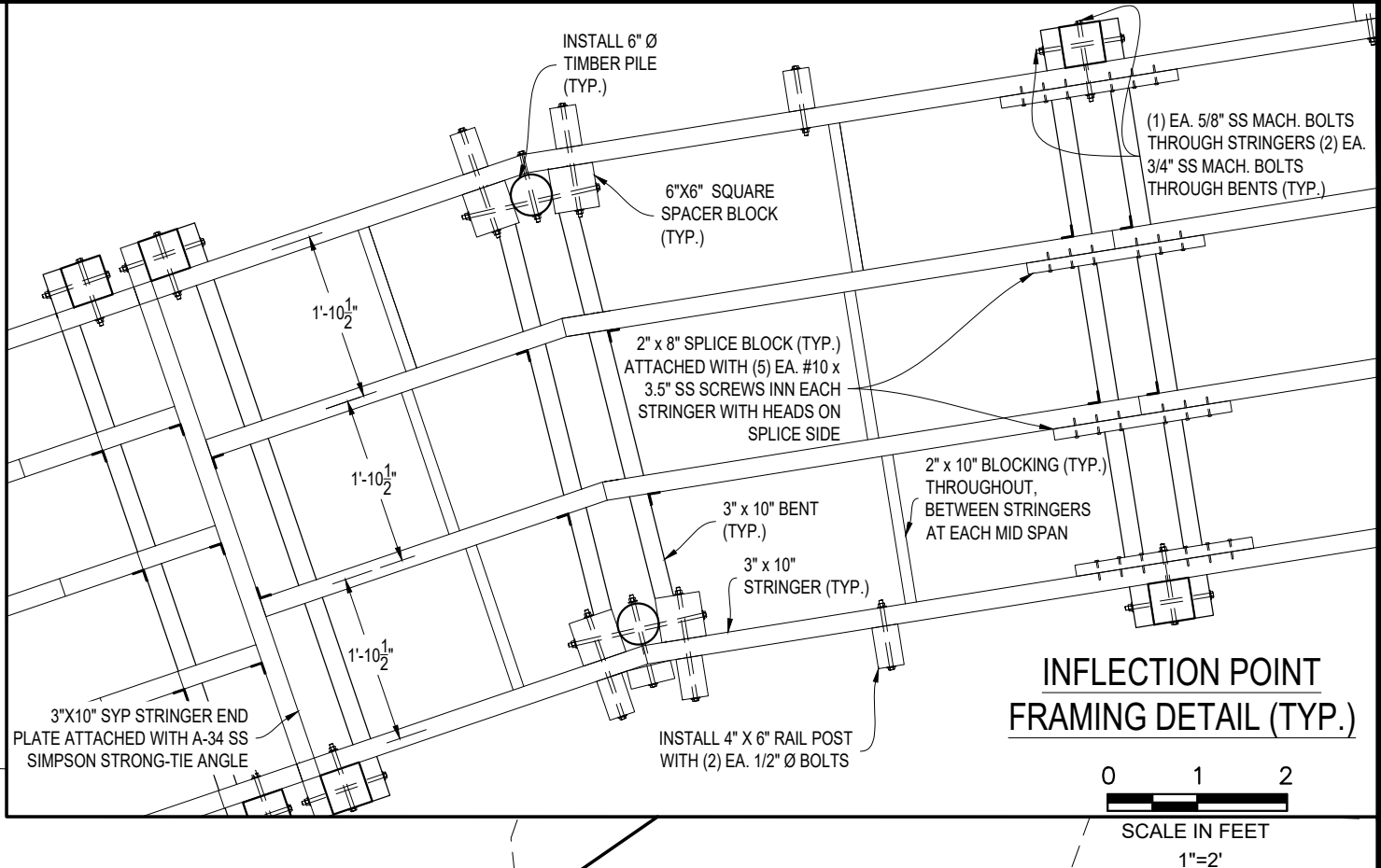
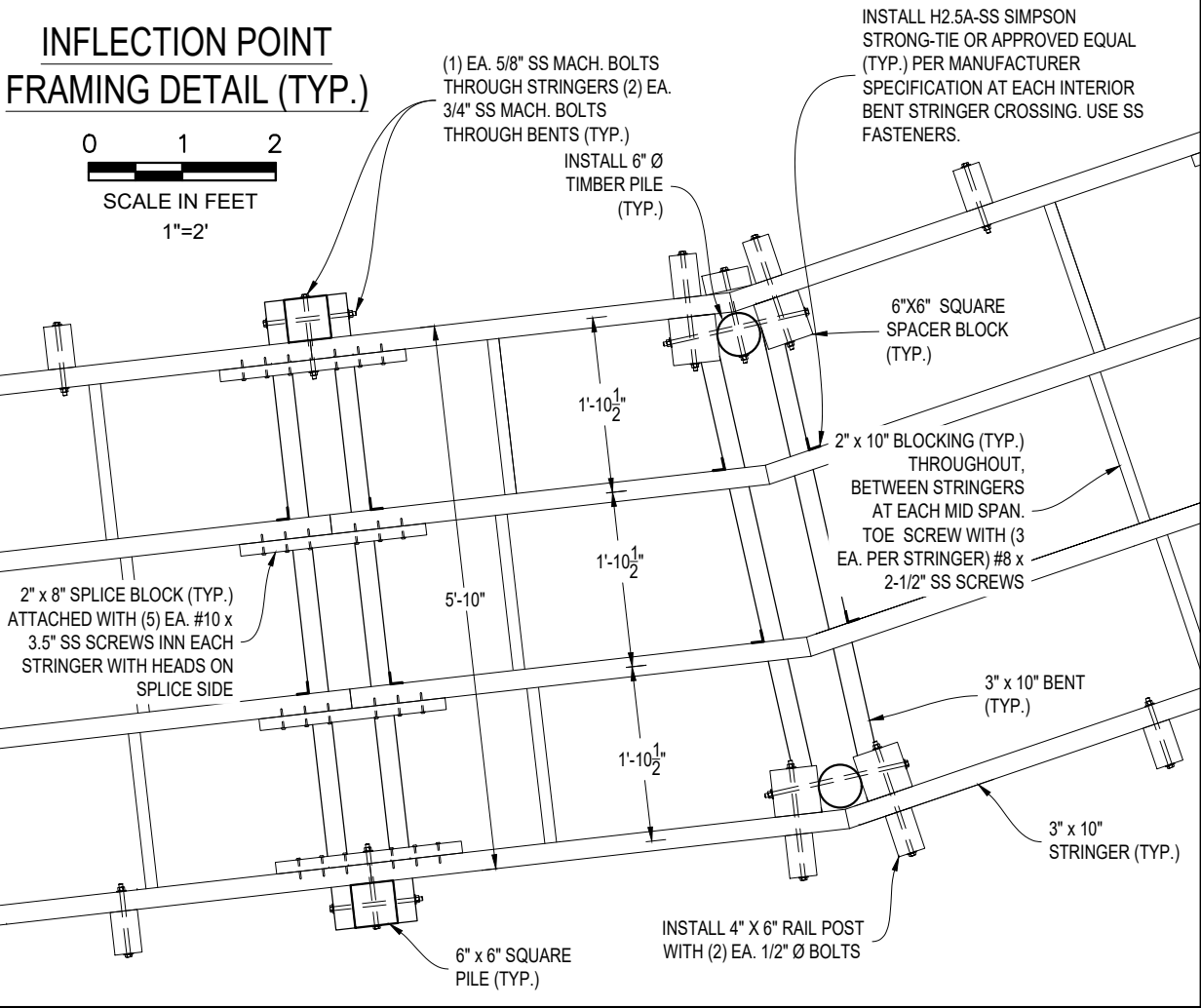

GENERAL NOTES:

- DATUM IS NAVD.
- EXISTING LOCATIONS AND ELEVATIONS ARE APPROXIMATE, BASED ON SURVEY BY R.L. VAUGHT & ASSOCIATES, INC., DATED 12/18/2024.

This item has been digitally signed and sealed by Mark A. Powell, P.E. on the date adjacent to the seal. Printed copies of this document are not considered signed and sealed and the signature must be verified on any electronic copies.

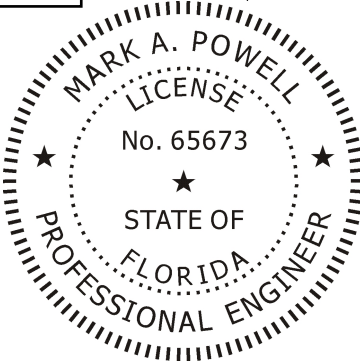

FRAMING PLAN

**ISIMINGER & STUBBS  
ENGINEERING, INC.**  
COASTAL • ENVIRONMENTAL • MARINE  
REGISTRATION NUMBER: 8114  
P.O. BOX 14702 - NORTH PALM BEACH, FL 33408 - 561-881-0003

DUNE WALKOVER CONSTRUCTION  
ATLANTIC OCEAN FRONTAGE  
DONALD ROSS ROAD AND OCEAN DRIVE  
JUNO BEACH, PALM BEACH COUNTY, FL  
CLIENT: TOWN OF JUNO BEACH

DATE	8/25	DRAWN	IBN	CHKD	MAP	APPRVD	MAP
DWG NO.	24147G5						SHEET
COMPUTER FILE NO.	24147G						OF 10

**5**

STRINGER-BENT  
CROSSING DETAIL  
N.T.S.

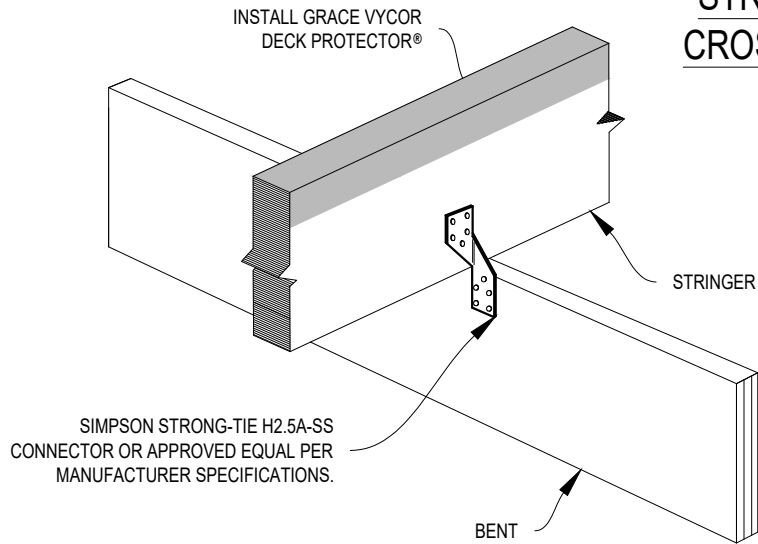

5/4" x 8" WEARDECK CAP RAIL (COLOR: GRAY). ATTACH TO POST/PILE WITH (2) #10 SS SCREWS (2) PER POST. ATTACH TO TOP RAIL, WITH SS #8 SCREW 24" O.C. BOARDS NO LONGER THAN 12'. END JOINT SHALL BE AT 6"x6" POSTS.

ALUM. GRIP ROD BRACKET (EQUALLY SPACE 4 FT. O.C. (MAX.), RAMP SECTIONS ONLY)

2" x 6" SYP TOP RAIL (TYP.)

3/8" SS CARRIAGE BOLTS ((2) AT EVERY POST FOR RAMP AND STAIR SECTIONS, (1) AT EVERY POST FOR ALL OTHER SEGMENTS)

SIMPSON STRONG-TIE® H2.5A SS OR APPROVED ALTERNATIVE (TYP.)

2" x 6" SYP INTERMEDIATE RAIL (TYP.). ATTACH WITH (1) EA. 3/8" SS CARRIAGE BOLT AND (2) EA. NO. 10 x 3 1/2" SS WOOD SCREWS

(1) EA. 5/8" SS MACH. BOLTS THROUGH STRINGERS (2) EA. 3/4" SS MACH. BOLTS THROUGH BENTS (TYP.)

3" x 10" STRINGER (TYP.). EQUALLY SPACED

3" x 10" BENT

6" SQUARE TIMBER PILE

TYPICAL SECTION  
DETAIL AT POST

0 1 2  
SCALE IN FEET  
1"=2'-0"

1-1/2" O.D. MARINE GRADE ALUM. GRIP ROD (RAMP SECTIONS ONLY). EXTENSIONS IN ACCORDANCE WITH FBC-ACCESSIBILITY, SECTION 505.10.2 AND 505.10.3 SHALL BE PROVIDED AT NO ADDITIONAL COST.

4x6 SYP RAIL POST (MIDSPAN OF TIMBER PILES)

(2) 1/2" Ø BOLTS (TYP.) THROUGH POSTS AND STRINGERS

3" x 10" STRINGER (TYP.). EQUALLY SPACED

TYPICAL SECTION DETAIL AT  
INTERMEDIATE RAIL POST

0 1 2  
SCALE IN FEET  
1"=2'-0"

EXIST. SEAGRAPE (SCHEM.)

SEAGRAPE CANOPY TO BE CAREFULLY TRIMMED FOR WALKING CLEARANCE

FULL WIDTH OF DECKED AREA PLUS OUTSIDE POSTS. DO NOT CUT MORE 3" PAST EDGE LINE

6'-8" (MIN.) 6'-11" (MAX.) FROM FINISH DECK ELEVATION. FOR BOTTOM OF TRIMMED CANOPY ABOVE STEPS, MEASURE FROM NOSING AND FOLLOW RAIL PROFILE

TREE TRIM DETAIL

0 1 2  
SCALE IN FEET  
1"=2'-0"

This item has been digitally signed and sealed by Mark A. Powell, P.E. on the date adjacent to the seal. Printed copies of this document are not considered signed and sealed and the signature must be verified on any electronic copies.

AUGUST 1, 2025

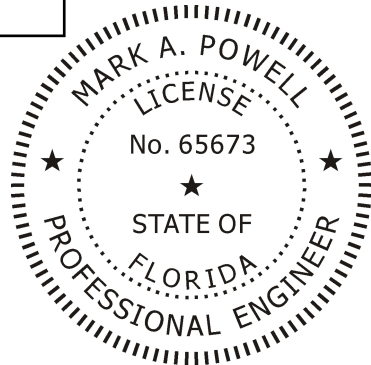

SECTION VIEWS

**ISIMINGER & STUBBS  
ENGINEERING, INC.**  
COASTAL • ENVIRONMENTAL • MARINE  
REGISTRATION NUMBER: 8114  
P.O. BOX 14702 - NORTH PALM BEACH, FL 33408 - 561-881-0003

DUNE WALKOVER IMPROVEMENTS  
ATLANTIC OCEAN FRONTAGE  
340 OCEAN DRIVE  
JUNO BEACH, PALM BEACH COUNTY, FL  
CLIENT: TOWN OF JUNO BEACH

DATE	8/25	DRAWN	IBN	CHKD	MAP	APPRVD	MAP
DWG NO.	24147G6						SHEET
COMPUTER FILE NO.	24147G						OF 10

# ELEVATION DETAIL

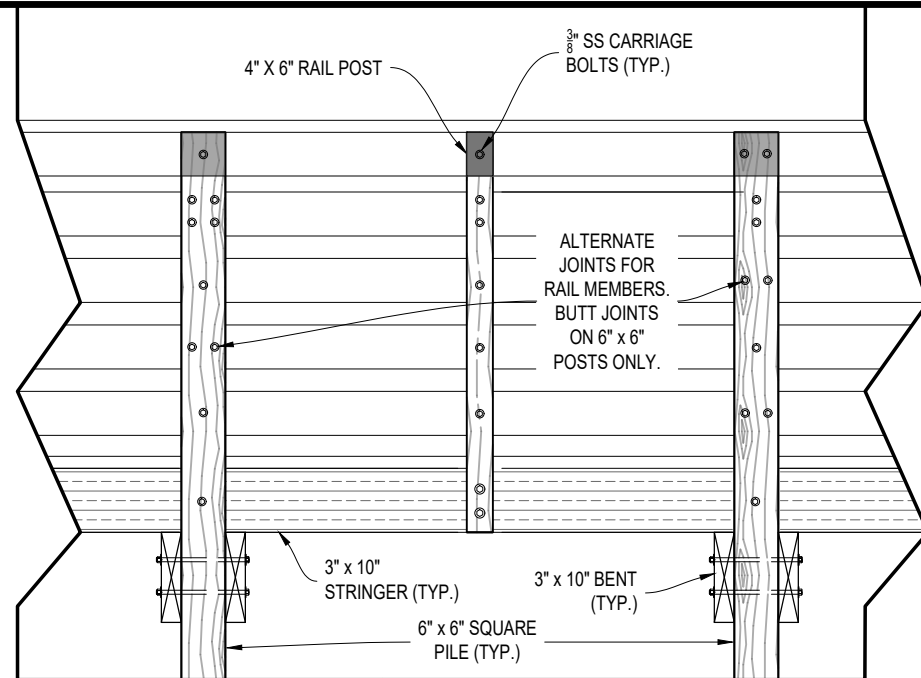
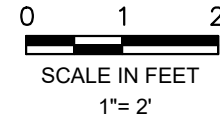

# TREAD DETAIL

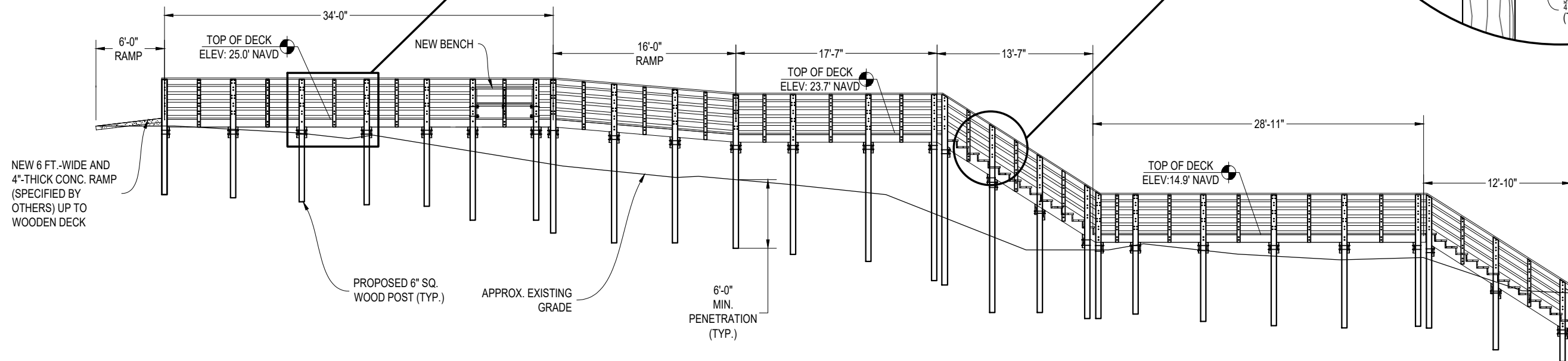
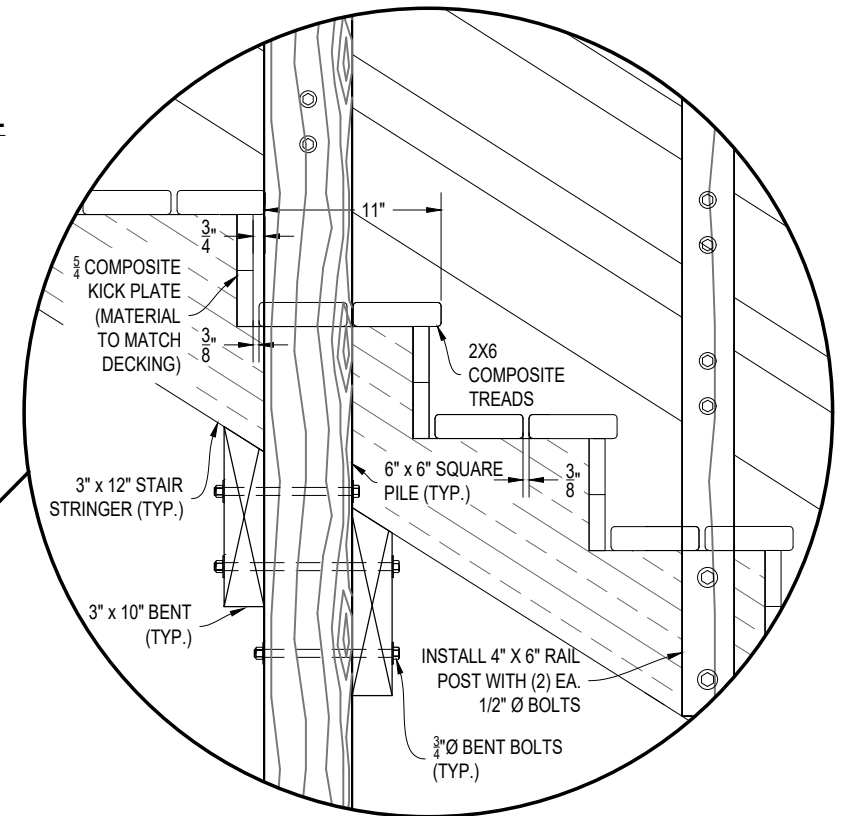

# ELEVATION VIEW

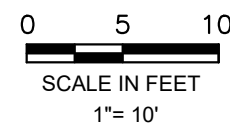

AUGUST 1, 2025

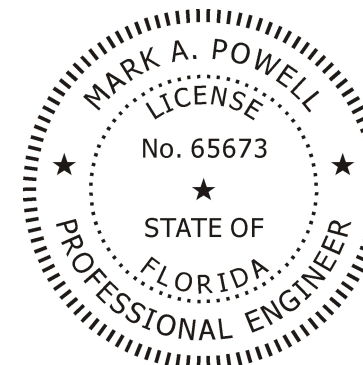

# ELEVATION VIEW

<b>ISIMINGER &amp; STUBBS ENGINEERING, INC.</b> <small>COASTAL • ENVIRONMENTAL • MARINE</small> <small>REGISTRATION NUMBER: 8114 P.O. BOX 14702 - NORTH PALM BEACH, FL 33408 - 561-881-0003</small>						
<b>DUNE WALKOVER IMPROVEMENTS ATLANTIC OCEAN FRONTAGE 340 OCEAN DRIVE JUNO BEACH, PALM BEACH COUNTY, FL CLIENT: TOWN OF JUNO BEACH</b>						
DATE	8/25	DRAWN	IBN	CHKD	MAP	APPRVD
DWG NO.	24147G7					SHEET
COMPUTER FILE NO.	24147G					OF 10

This item has been digitally signed and sealed by Mark A. Powell, P.E. on the date adjacent to the seal. Printed copies of this document are not considered signed and sealed and the signature must be verified on any electronic copies.



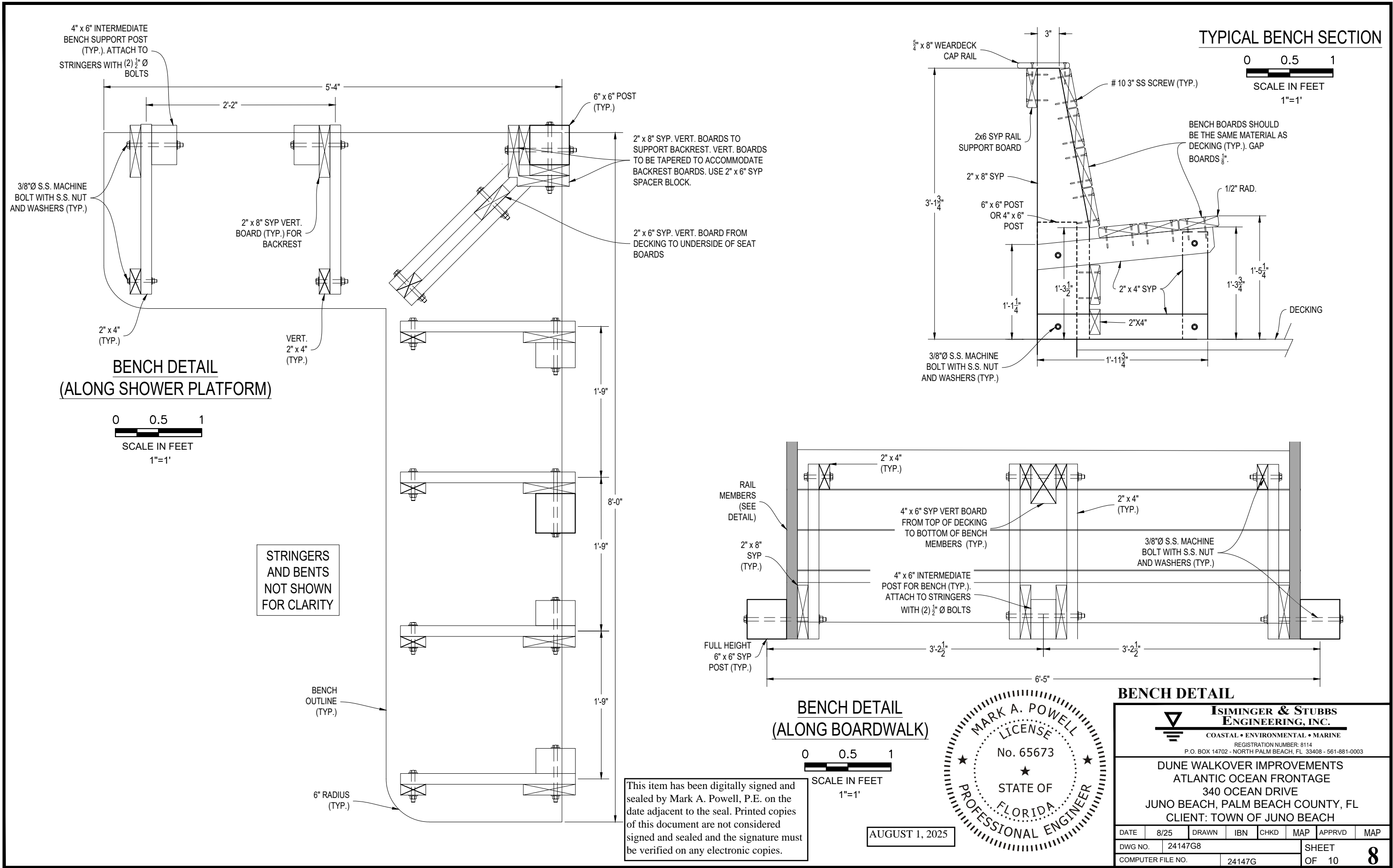



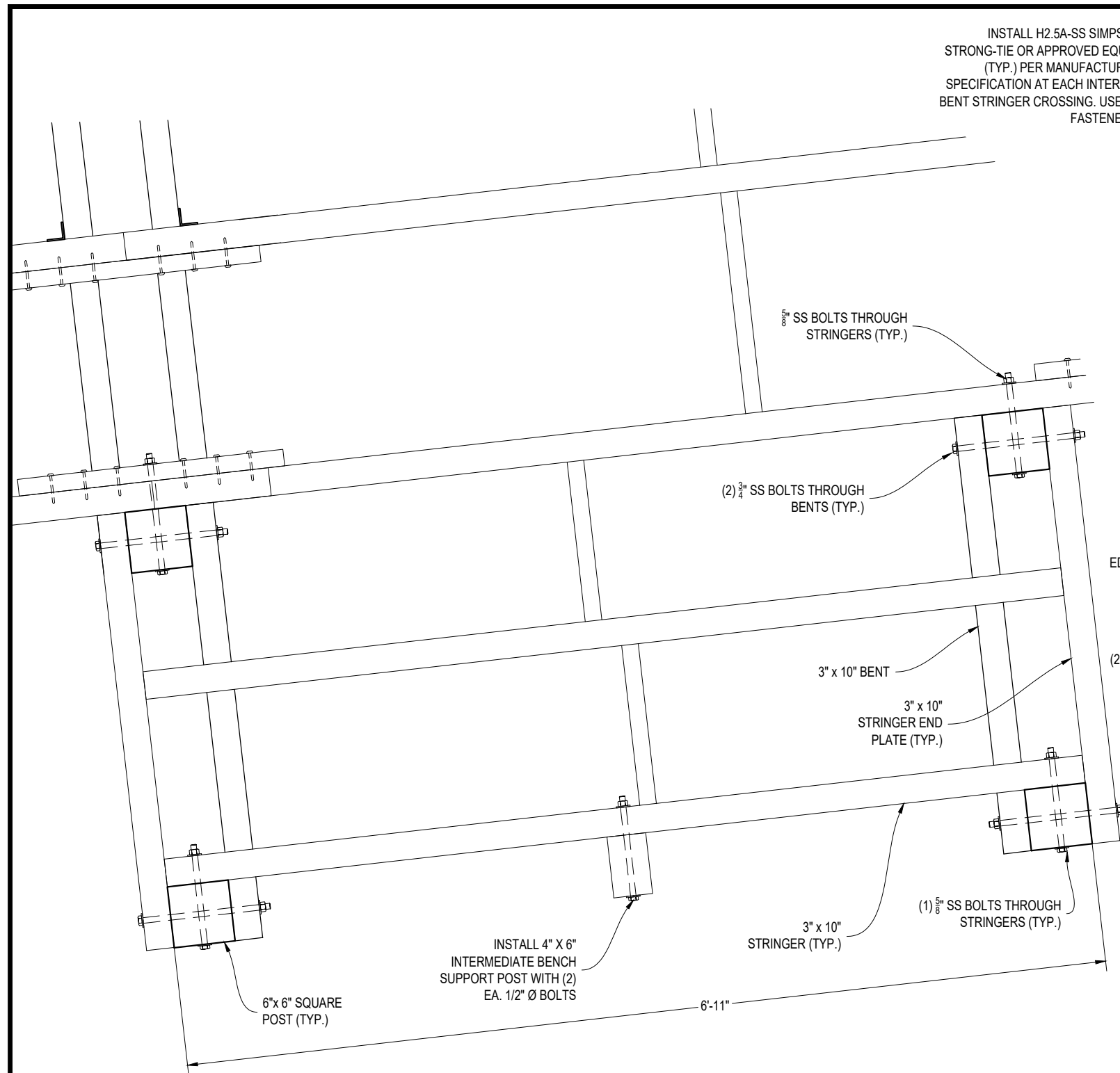

**BENCH PLATFORM FRAMING DETAIL  
(ALONG BOARDWALK)**

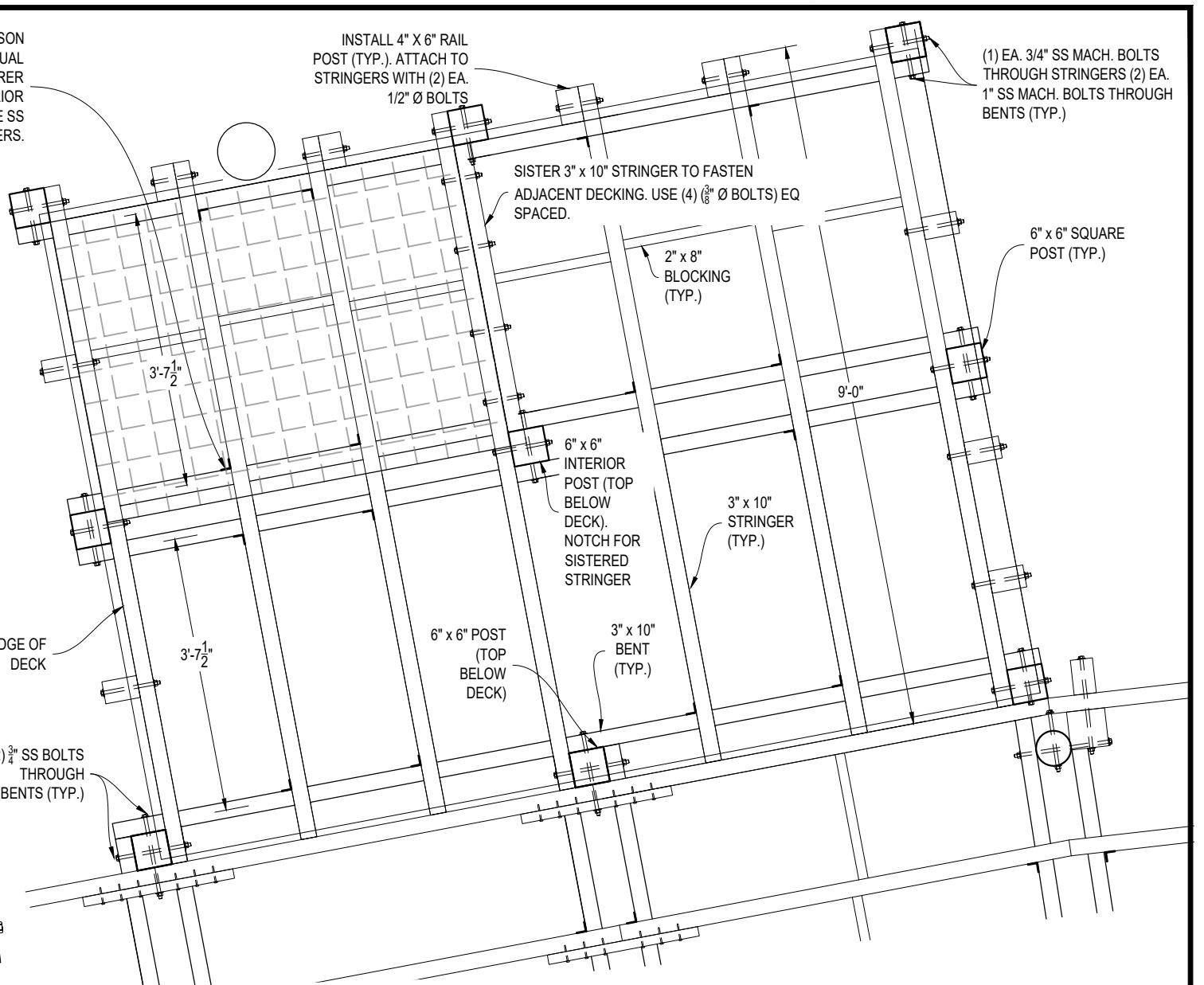
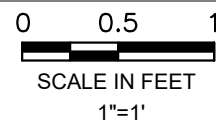

**SHOWER PLATFORM  
FRAMING DETAIL**



AUGUST 1, 2025

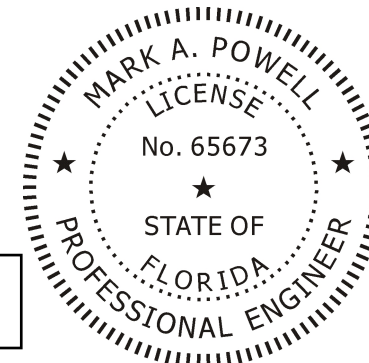

**PLATFORM FRAMING DETAIL**

**ISIMINGER & STUBBS  
ENGINEERING, INC.**  
COASTAL • ENVIRONMENTAL • MARINE  
REGISTRATION NUMBER: 8114  
P.O. BOX 14702 - NORTH PALM BEACH, FL 33408 - 561-881-0003

DUNE WALKOVER IMPROVEMENTS  
ATLANTIC OCEAN FRONTAGE  
340 OCEAN DRIVE  
JUNO BEACH, PALM BEACH COUNTY, FL  
CLIENT: TOWN OF JUNO BEACH

DATE	8/25	DRAWN	IBN	CHKD	MAP	APPRVD	MAP
DWG NO.	24147G9						SHEET
COMPUTER FILE NO.	24147G						OF 10

**9**

This item has been digitally signed and sealed by Mark A. Powell, P.E. on the date adjacent to the seal. Printed copies of this document are not considered signed and sealed and the signature must be verified on any electronic copies.

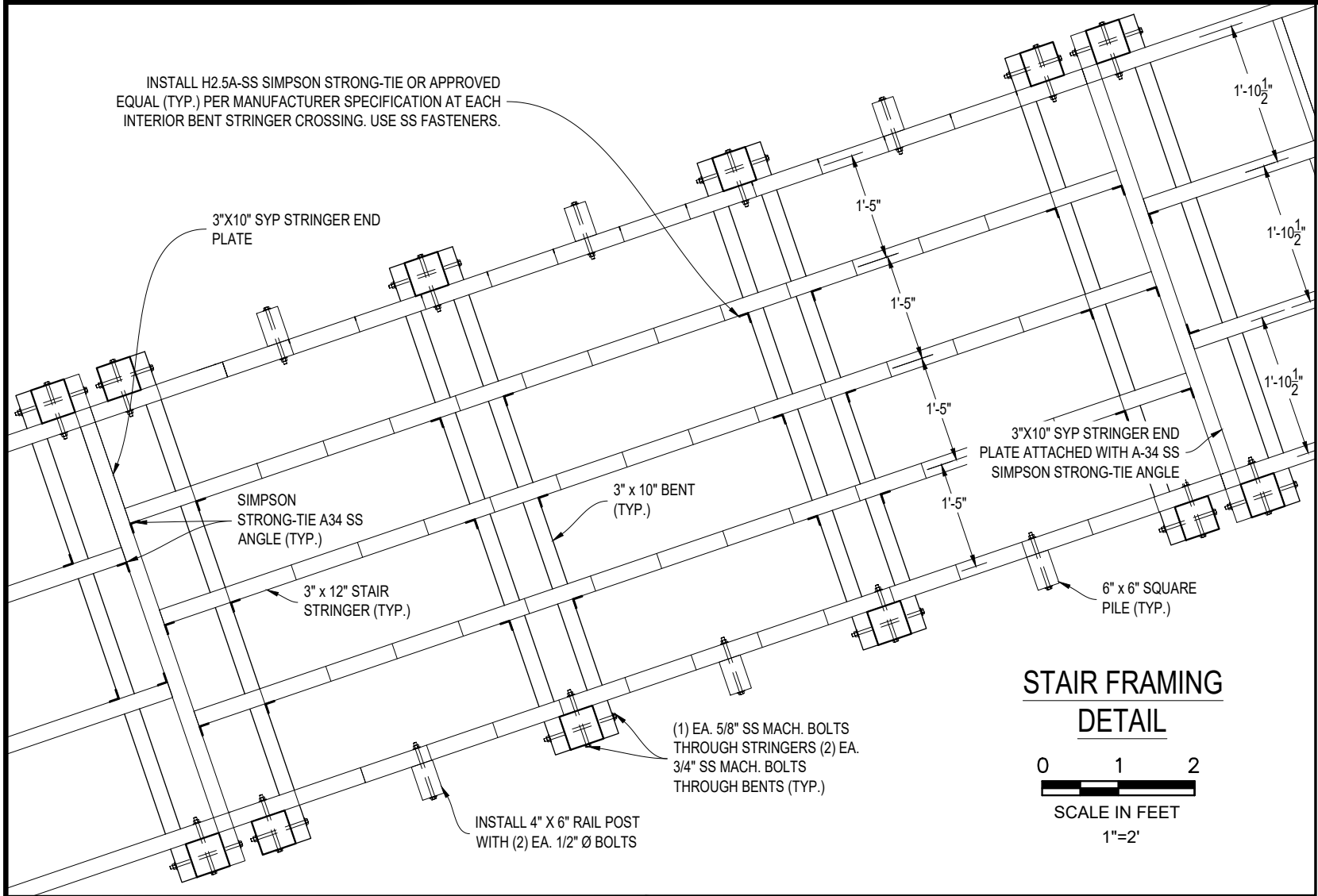

STAIR FRAMING  
DETAIL

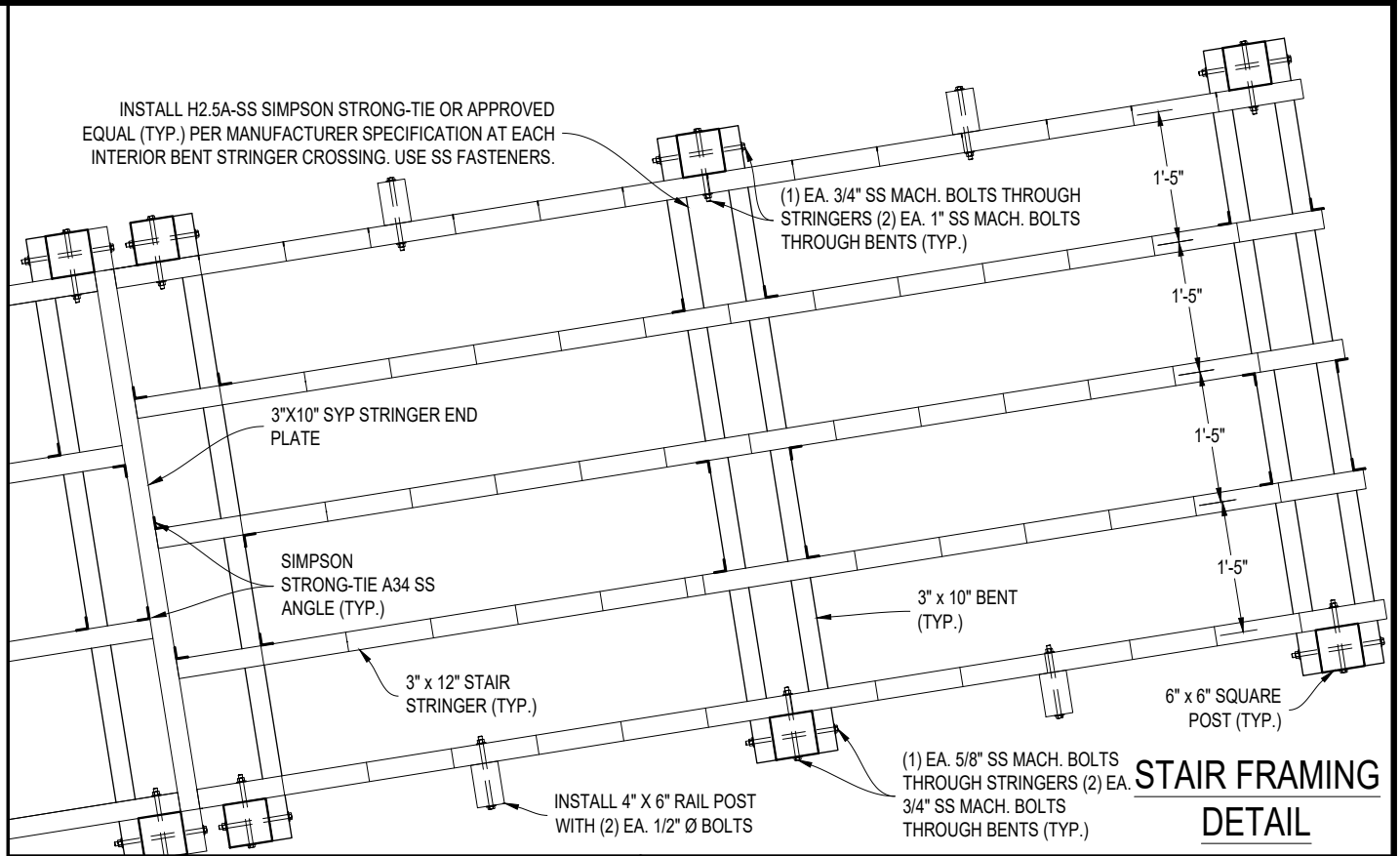
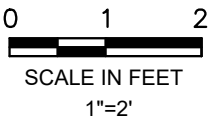

STAIR FRAMING  
DETAIL

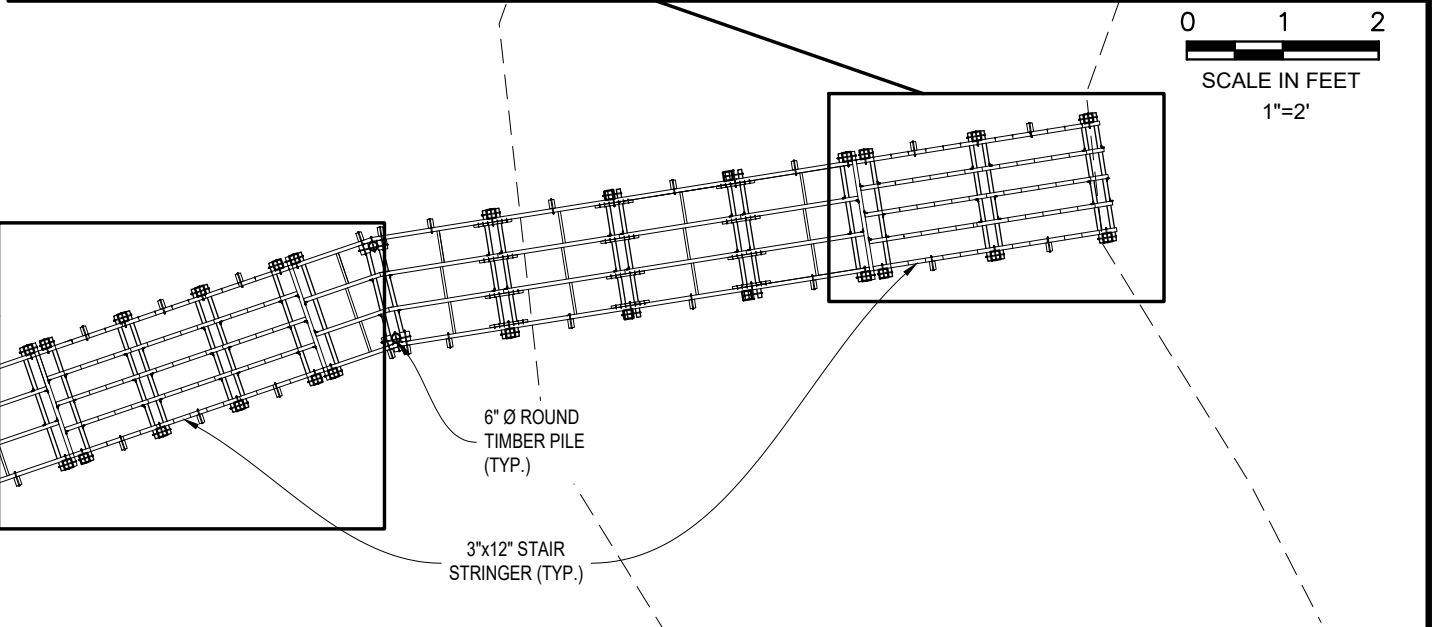
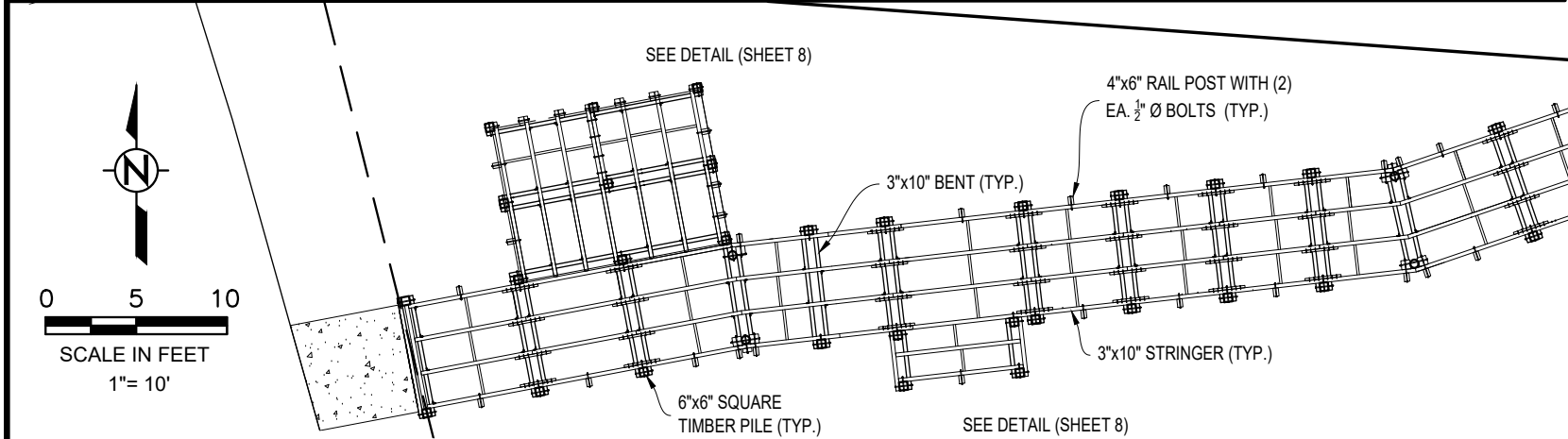
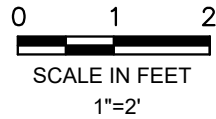

AUGUST 1, 2025

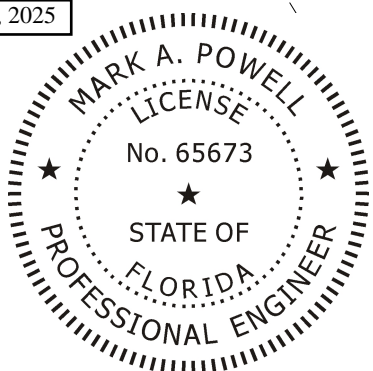

STAIR DETAIL

**ISIMINGER & STUBBS  
ENGINEERING, INC.**  
COASTAL • ENVIRONMENTAL • MARINE  
REGISTRATION NUMBER: 8114  
P.O. BOX 14702 - NORTH PALM BEACH, FL 33408 - 561-881-0003

DUNE WALKOVER CONSTRUCTION  
ATLANTIC OCEAN FRONTAGE  
DONALD ROSS ROAD AND OCEAN DRIVE  
JUNO BEACH, PALM BEACH COUNTY, FL  
CLIENT: TOWN OF JUNO BEACH

DATE	8/25	DRAWN	IBN	CHKD	MAP	APPRVD	MAP
DWG NO.	24147G10						SHEET
COMPUTER FILE NO.	24147G						OF 10

10

GENERAL NOTES:

- DATUM IS NAVD.
- EXISTING LOCATIONS AND ELEVATIONS ARE APPROXIMATE, BASED ON SURVEY BY R.L. VAUGHT & ASSOCIATES, INC., DATED 12/18/2024.

This item has been digitally signed and sealed by Mark A. Powell, P.E. on the date adjacent to the seal. Printed copies of this document are not considered signed and sealed and the signature must be verified on any electronic copies.