

SITE DEVELOPMENT PLANS CELESTIAL WAY DRAINAGE IMPROVEMENTS

SECTION 28, TOWNSHIP 41S., RANGE 43E.
THE TOWN OF JUNO BEACH, FLORIDA

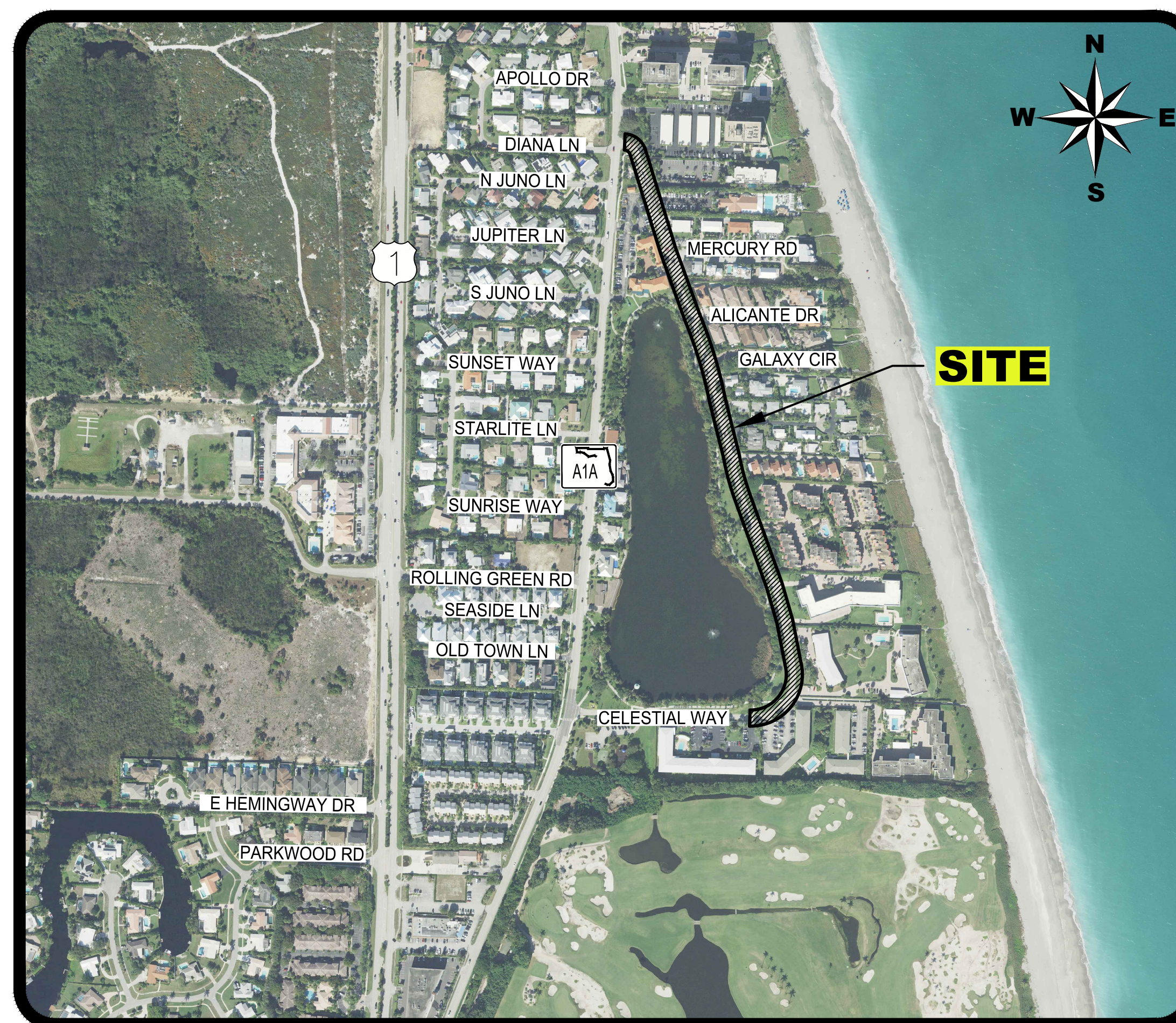
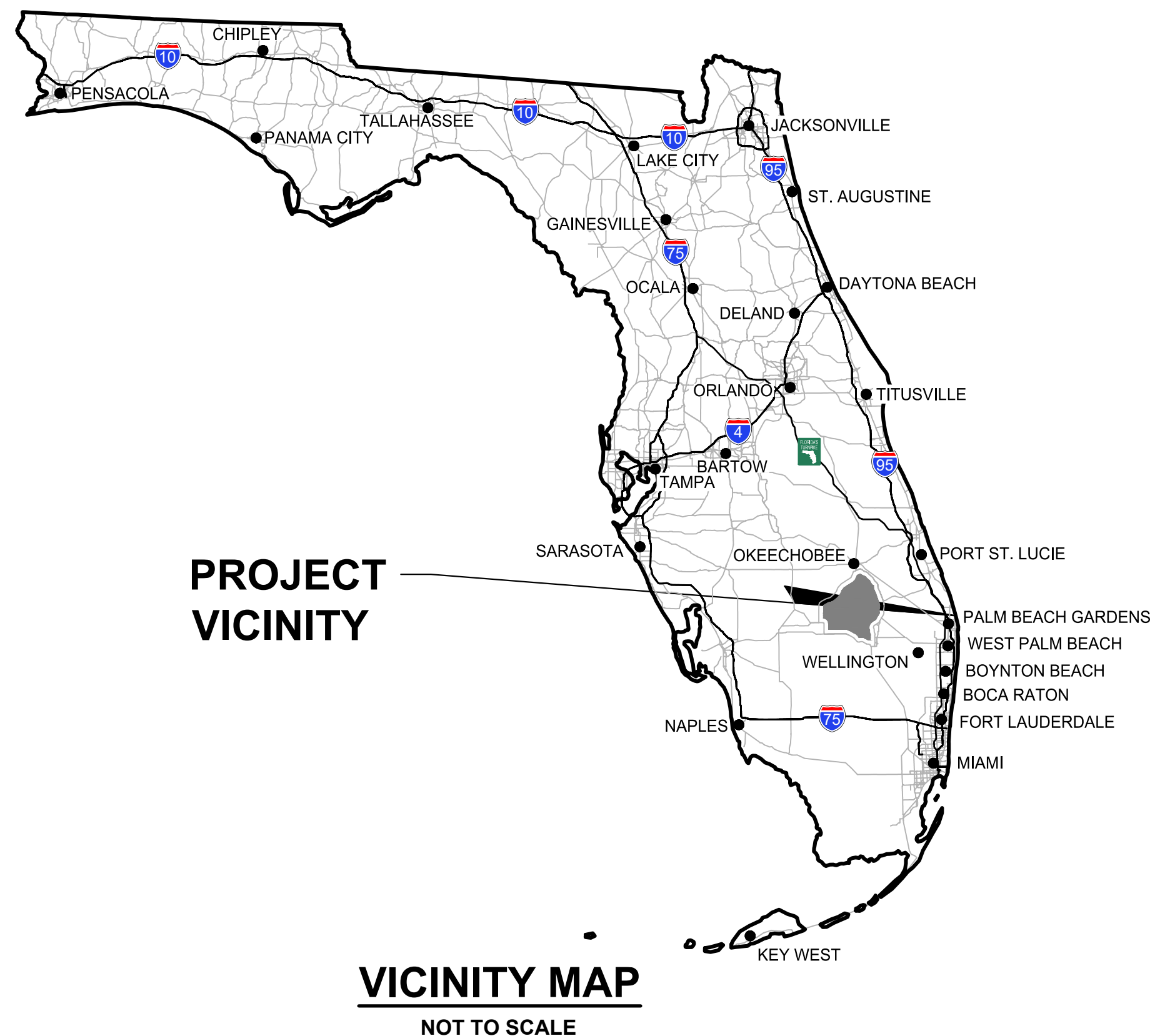

INDEX OF SHEETS

SHEET NO.:	DESCRIPTION:
1	TITLE SHEET
2	MASTER PLAN
3-6	SITE DEVELOPMENT PLAN
7	SITE DEVELOPMENT DETAILS
8	POLLUTION PREVENTION PLAN

BID SET

THIS ITEM HAS BEEN DIGITALLY
SIGNED AND SEALED BY
PAUL ANTON BURI, P.E. ON
3/6/2024.

PRINTED COPIES OF THIS
DOCUMENT ARE NOT
CONSIDERED SIGNED AND
SEALED AND THE SIGNATURE
MUST BE VERIFIED ON ANY
ELECTRONIC COPIES.

REVISIONS

SIMMONS & WHITE
ENGINEERING | PLANNING | CONSULTING | SINCE 1982
2581 Metrocentre Blvd West • Suite 300 • West Palm Beach, Florida 33407 • (561) 478-7848

DESIGN	DRAWN	CHECKED	APPROVED	DATE
P.B.	R.W.			

CELESTIAL WAY
SECTION 28, TOWNSHIP 41S., RANGE 43E.
THE TOWN OF JUNO BEACH, FLORIDA
TITLE SHEET

JOB NO.	DRAWING NO.	SHEET	OF
22-004.21	22004.21S01	1	8

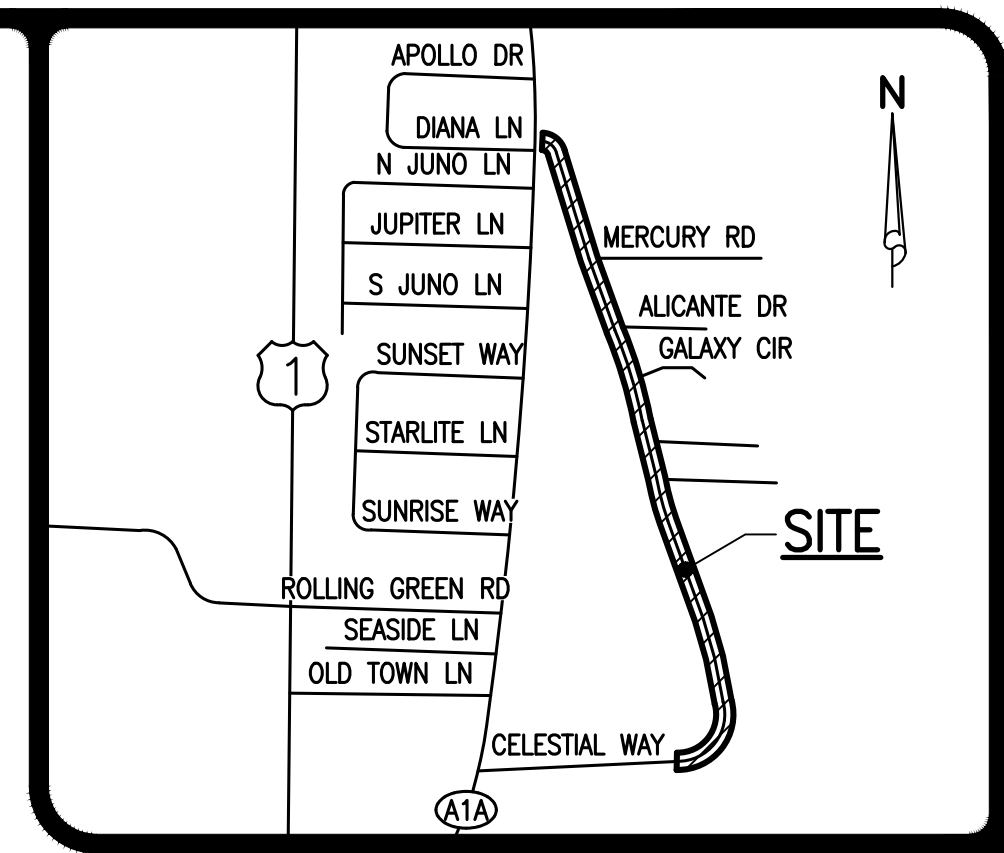

LOCATION MAP
NOT TO SCALE

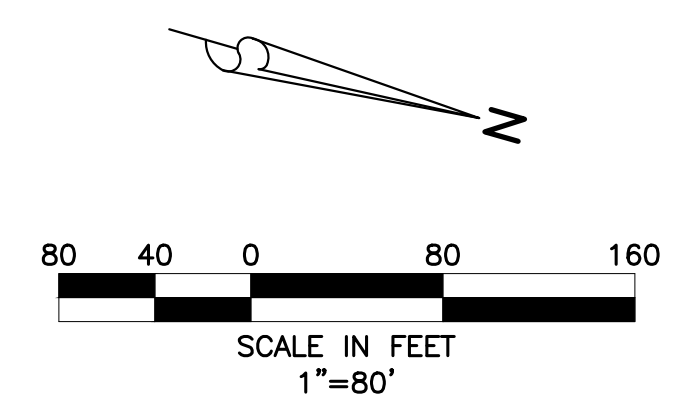

48 HOURS BEFORE DIGGING
BROWARD • PALM BEACH • INDIAN RIVER
ST. LUCIE • MARTIN COUNTIES
CALL FOR PERMITS
1-800-432-4770
SUNSHINE STATE 1 CALL
UNDERGROUND UTILITIES
NOTIFICATION CENTER

NOTE: ALL ELEVATIONS SHOWN HEREON ARE RELATIVE TO THE NORTH AMERICAN VERTICAL DATUM (N.A.V.D.) OF 1988 BASED ON A SURVEY PREPARED BY LIDBERG LAND SURVEYING, INC. (561) 746-8454.

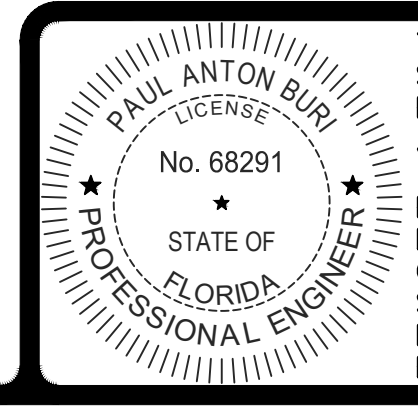

THIS ITEM HAS BEEN DIGITALLY
SIGNED AND SEALED BY
PAUL ANTON BURI, P.E. ON
3/6/2024.
PRINTED COPIES OF THIS
DOCUMENT ARE NOT
CONSIDERED SIGNED AND
SEALED AND THE SIGNATURE
MUST BE VERIFIED ON ANY
ELECTRONIC COPIES.



DESIGN P.B.	DRAWN R.W.	CHECKED	APPROVED	DATE
----------------	---------------	---------	----------	------

BID SET
CELESTIAL WAY
SECTION 28, TOWNSHIP 41S., RANGE 43E.
THE TOWN OF JUNO BEACH, FLORIDA
MASTER PLAN

JOB NO. 22-004.21	DRAWING NO. 22004.21S02	SHEET 2 OF 8
----------------------	----------------------------	-----------------

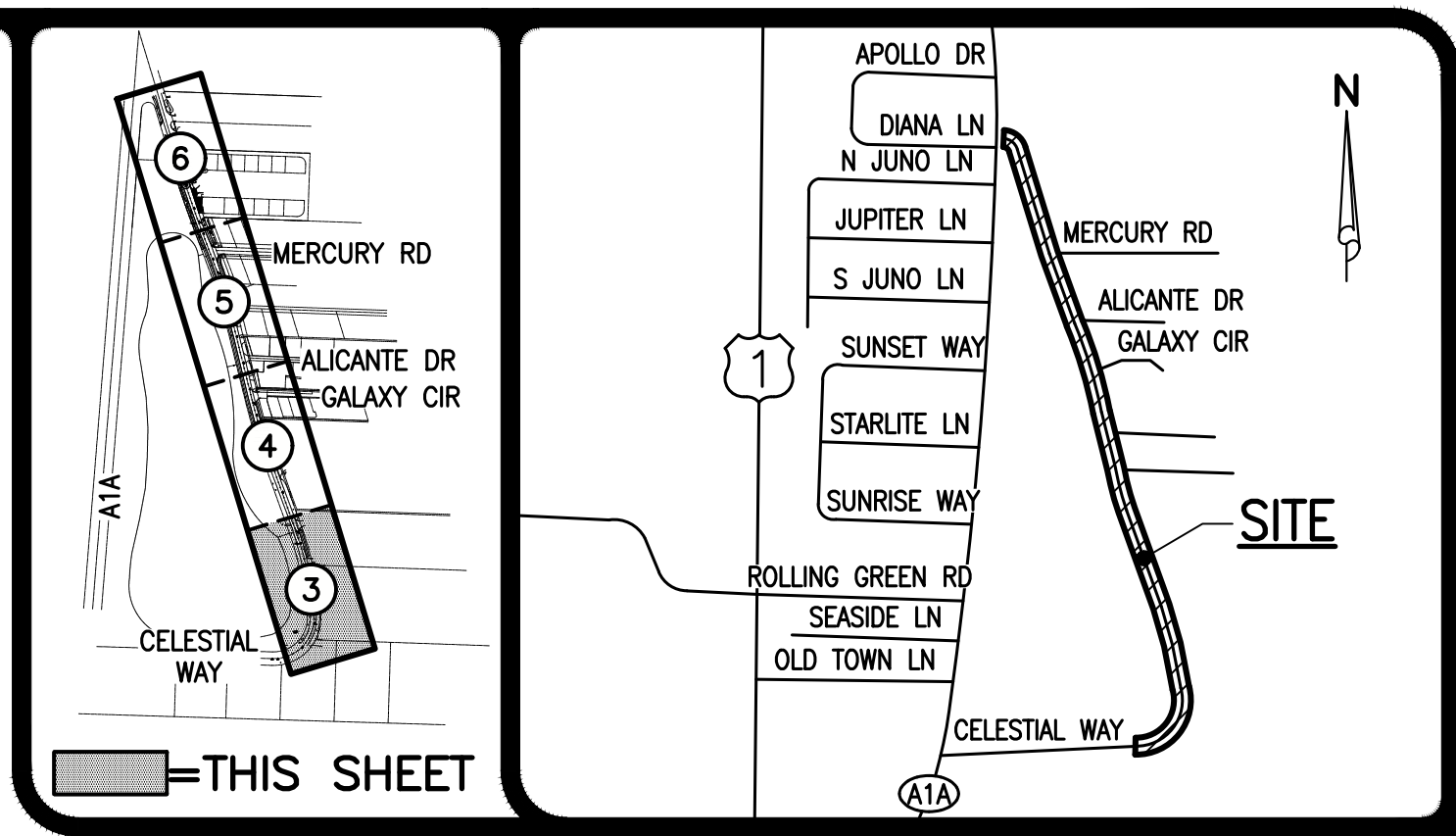

KEY MAP
NOT TO SCALE

LOCATION MAP
NOT TO SCALE

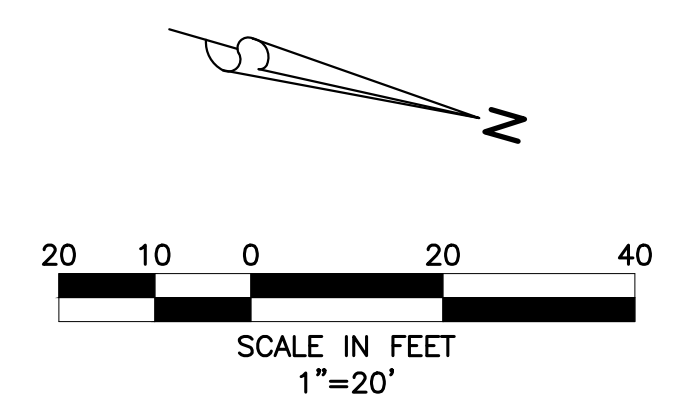

LEGEND

- A3-C INLET NUMBER AND TYPE
- 19.5 INLET TOP ELEVATION
- 16.0 INVERT ELEVATION
- PROPOSED YARD DRAIN (SEE DETAIL SHEET 7)
- PROPOSED SWALE
- X 19.0 PROPOSED GRADE ELEVATION
- X 13.96 EXISTING GRADE ELEVATION
- PROPOSED PERVIOUS PAVERS (SEE DETAIL SHEET 7)
- LIMITS OF SWALE
- EXISTING OVERHEAD POWER LINE & POWER POLE
- EXISTING STORM DRAINAGE PIPE
- EXISTING WATER MAIN
- EXISTING SEWER MAIN
- EXISTING FORCE MAIN
- ABBREVIATIONS**
- H.D.P.E. HIGH DENSITY POLYETHYLENE
- P.V.C. POLYVINYL CHLORIDE PIPE

MATCH LINE SEE SHEET 4

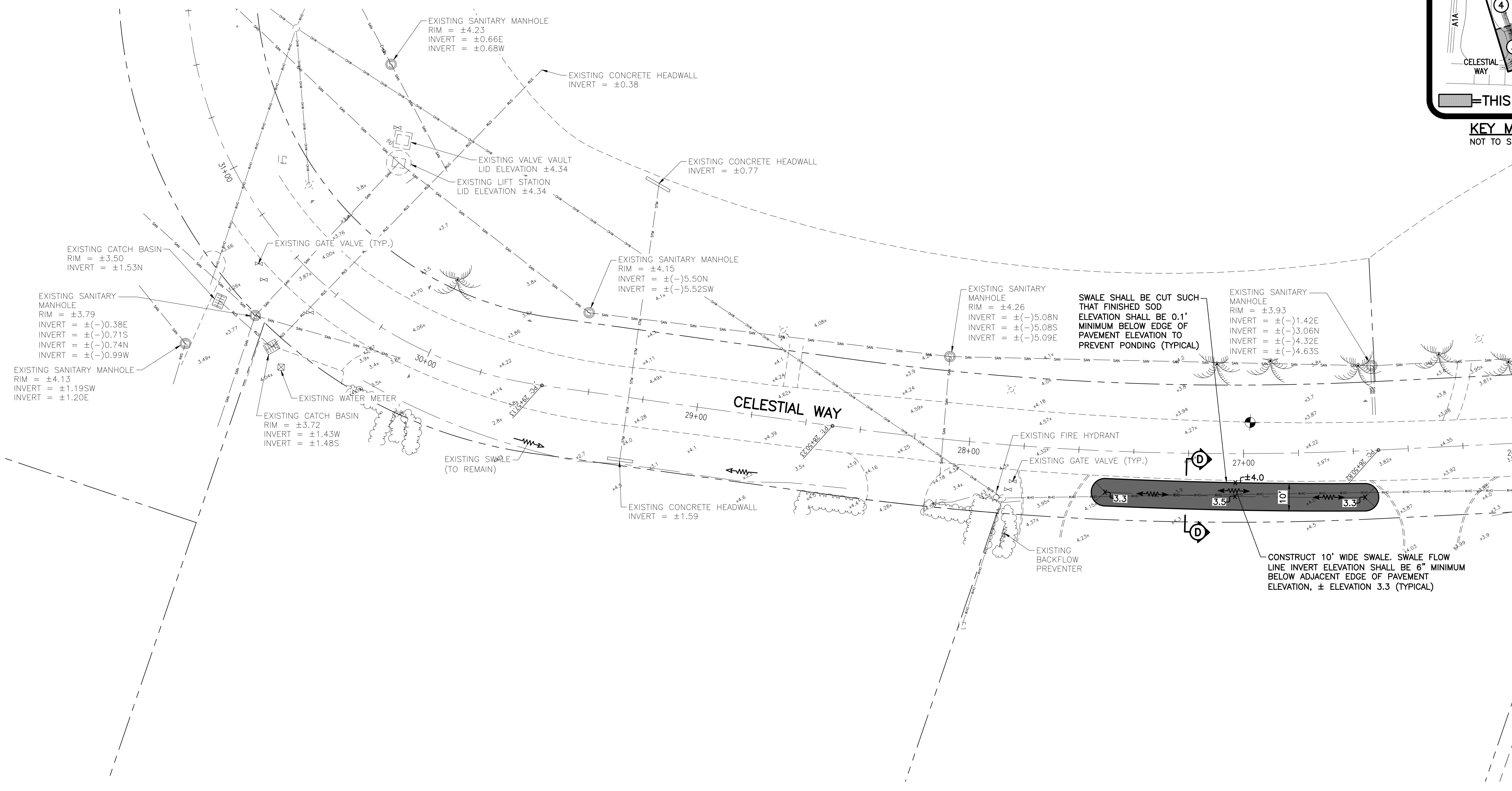

SWALE SHALL BE CUT SUCH THAT FINISHED SOD ELEVATION SHALL BE 0.1' MINIMUM BELOW EDGE OF PAVEMENT ELEVATION TO PREVENT PONDING (TYPICAL)

CONSTRUCT 10' WIDE SWALE. SWALE FLOW LINE INVERT ELEVATION SHALL BE 6" MINIMUM BELOW ADJACENT EDGE OF PAVEMENT ELEVATION, ± ELEVATION 3.3 (TYPICAL)

- NOTES:**
- 1.) CONTRACTOR TO FIELD VERIFY LOCATION AND DEPTH OF ALL EXISTING UTILITIES PRIOR TO CONSTRUCTION AND NOTIFY ENGINEER OF ANY CONFLICTS. IT SHALL BE THE CONTRACTOR'S RESPONSIBILITY TO COORDINATE ALL EXISTING UTILITY LOCATES, SUPPORT, RELOCATIONS AND NOTIFICATIONS REQUIRED WITH ALL APPLICABLE UTILITY SERVICE PROVIDERS.
 - 2.) SWALE BOTTOM ELEVATION SHALL BE ADJUSTED AS NEEDED TO MAINTAIN 6" MINIMUM DEPTH TO INVERT AS MEASURED FROM ADJACENT E.O.P.. CONTRACTOR SHALL NOTIFY ENGINEER OF ANY CONFLICTS PRIOR TO CONSTRUCTION.
 - 3.) CONTRACTOR SHALL BE RESPONSIBLE FOR RESTORING ALL ON-SITE & OFF-SITE AREAS DISTURBED DURING CONSTRUCTION TO EXISTING OR BETTER CONDITION.
 - 4.) CONTRACTOR SHALL BE RESPONSIBLE FOR ALL N.P.D.E.S. REQUIREMENTS INCLUDING FILING OF N.O.I., N.O.T., WEEKLY & MONTHLY MONITORING REPORTS, ETC.
 - 5.) ALL DRAINAGE STRUCTURES SHALL HAVE 12" MINIMUM SUMP.

48 HOURS BEFORE DIGGING
BROWARD • PALM BEACH • INDIAN RIVER
ST. LUCIE • MARTIN COUNTIES
CALL FOR PERMITS
1-800-432-4770
SUNSHINE STATE 1 CALL
UNDERGROUND UTILITIES
NOTIFICATION CENTER

NOTE: ALL ELEVATIONS SHOWN HEREON ARE RELATIVE TO THE NORTH AMERICAN VERTICAL DATUM (N.A.V.D.) OF 1988 BASED ON A SURVEY PREPARED BY LIDBERG LAND SURVEYING, INC. (561) 746-8454.

THIS ITEM HAS BEEN DIGITALLY SIGNED AND SEALED BY PAUL ANTON BURI, P.E. ON 3/6/2024.

PRINTED COPIES OF THIS DOCUMENT ARE NOT CONSIDERED SIGNED AND SEALED AND THE SIGNATURE MUST BE VERIFIED ON ANY ELECTRONIC COPIES.

1.) ADDED STATIONING IN ROADWAY PER TOWN OF JUNO BEACH, 3/5/24.

SIMMONS & WHITE
ENGINEERING | PLANNING | CONSULTING | SINCE 1982
2581 Metrocentre Blvd West • Suite 3 • West Palm Beach, Florida 33407 • (561) 478-7848

DESIGN	DRAWN	CHECKED	APPROVED	DATE
P.B.	R.W.			

BID SET

CELESTIAL WAY
SECTION 28, TOWNSHIP 41S., RANGE 43E.
THE TOWN OF JUNO BEACH, FLORIDA
SITE DEVELOPMENT PLAN

JOB NO.	DRAWING NO.	SHEET	OF
22-004.21	22004.21S03	3	8

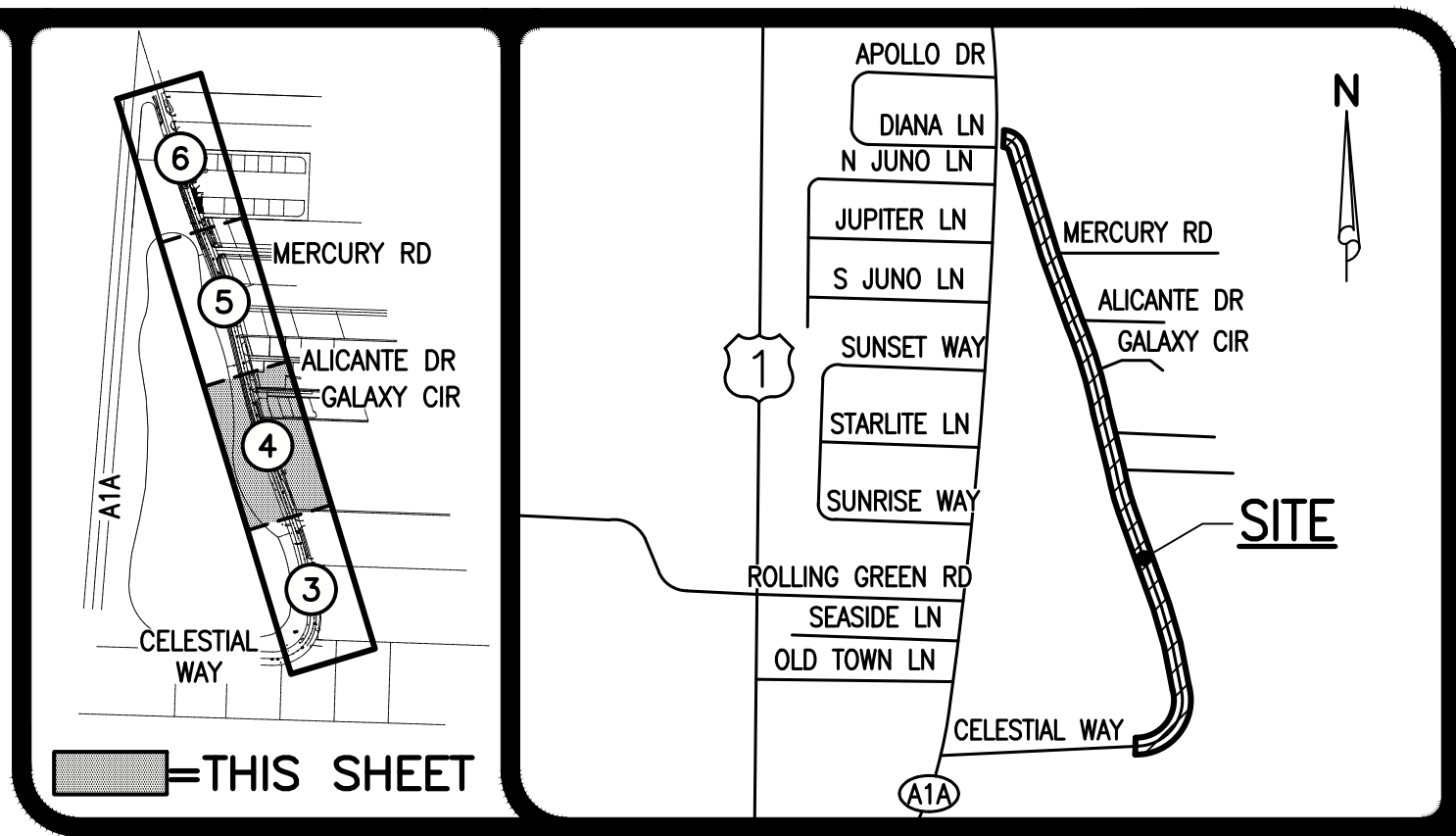

KEY MAP
NOT TO SCALE

LOCATION MAP
NOT TO SCALE

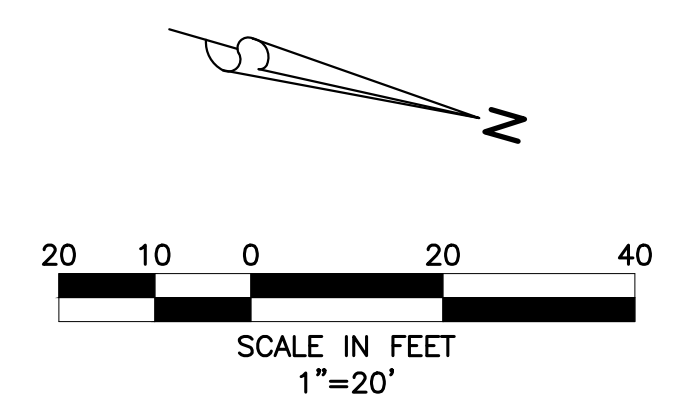

LEGEND

- A3-"C" INLET NUMBER AND TYPE
 - 19.5 INLET TOP ELEVATION
 - 16.0 INVERT ELEVATION
 - PROPOSED YARD DRAIN (SEE DETAIL SHEET 7)
 - PROPOSED SWALE
 - PROPOSED GRADE ELEVATION
 - EXISTING GRADE ELEVATION
 - PROPOSED PERVIOUS PAVERS (SEE DETAIL SHEET 7)
 - LIMITS OF SWALE
 - EXISTING OVERHEAD POWER LINE & POWER POLE
 - EXISTING STORM DRAINAGE PIPE
 - EXISTING WATER MAIN
 - EXISTING SEWER MAIN
 - EXISTING FORCE MAIN
- ABBREVIATIONS**
- H.D.P.E. HIGH DENSITY POLYETHYLENE
 - P.V.C. POLYVINYL CHLORIDE PIPE

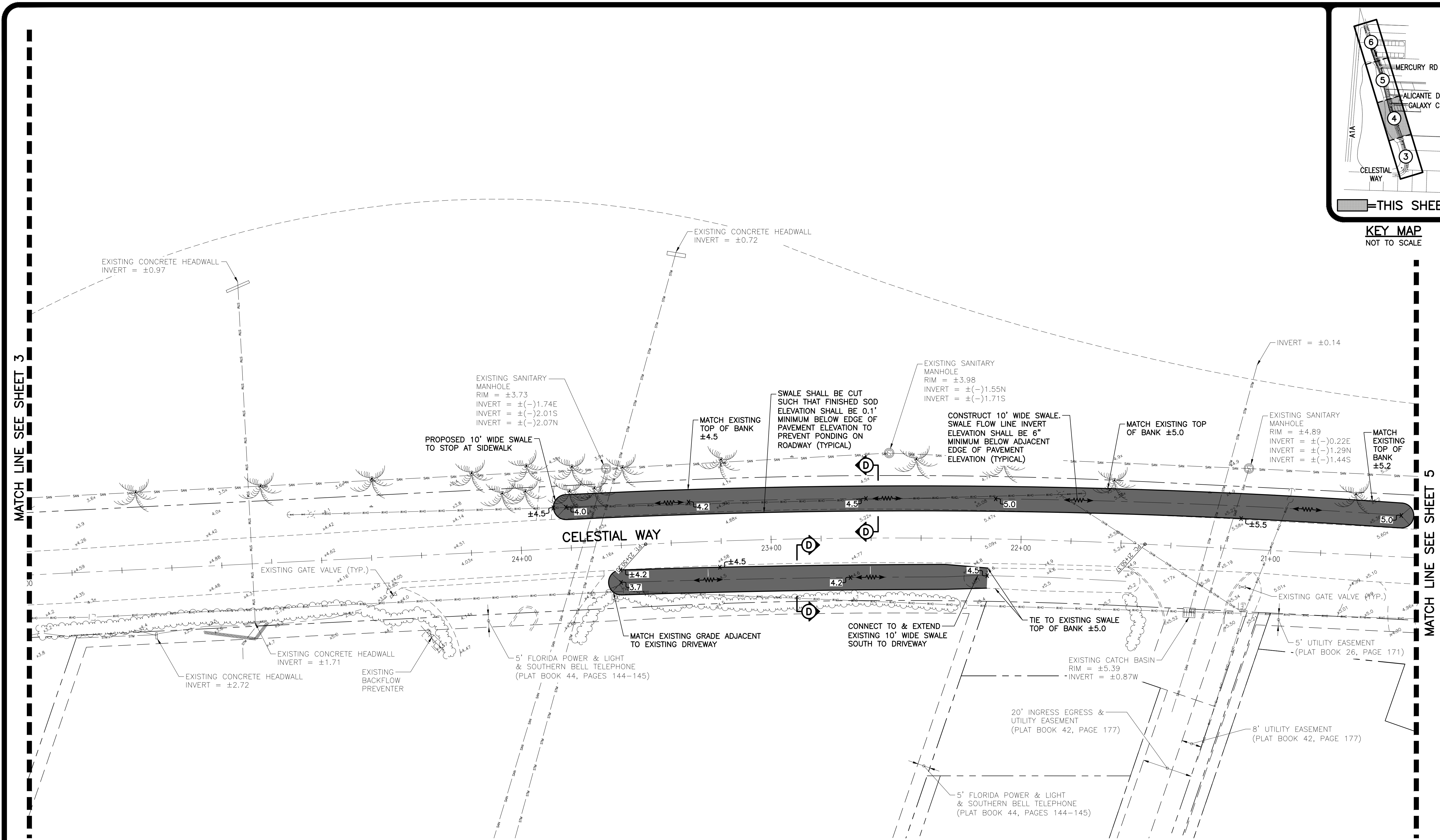

NOTES:

- CONTRACTOR TO FIELD VERIFY LOCATION AND DEPTH OF ALL EXISTING UTILITIES PRIOR TO CONSTRUCTION AND NOTIFY ENGINEER OF ANY CONFLICTS. IT SHALL BE THE CONTRACTOR'S RESPONSIBILITY TO COORDINATE ALL EXISTING UTILITY LOCATES, SUPPORT, RELOCATIONS AND NOTIFICATIONS REQUIRED WITH ALL APPLICABLE UTILITY SERVICE PROVIDERS.
- SWALE BOTTOM ELEVATION SHALL BE ADJUSTED AS NEEDED TO MAINTAIN 6" MINIMUM DEPTH TO INVERT AS MEASURED FROM ADJACENT E.O.P.. CONTRACTOR SHALL NOTIFY ENGINEER OF ANY CONFLICTS PRIOR TO CONSTRUCTION.
- CONTRACTOR SHALL BE RESPONSIBLE FOR RESTORING ALL ON-SITE & OFF-SITE AREAS DISTURBED DURING CONSTRUCTION TO EXISTING OR BETTER CONDITION.
- CONTRACTOR SHALL BE RESPONSIBLE FOR ALL N.P.D.E.S. REQUIREMENTS INCLUDING FILING OF N.O.I., N.O.T., WEEKLY & MONTHLY MONITORING REPORTS, ETC.
- ALL DRAINAGE STRUCTURES SHALL HAVE 12" MINIMUM SUMP.

MATCH LINE SEE SHEET 3

MATCH LINE SEE SHEET 5

48 HOURS BEFORE DIGGING
BROWARD • PALM BEACH • INDIAN RIVER
ST. LUCIE • MARTIN COUNTIES
CALL FOR PERMITS
1-800-432-4770
SUNSHINE STATE 1 CALL
UNDERGROUND UTILITIES
NOTIFICATION CENTER

NOTE: ALL ELEVATIONS SHOWN HEREON ARE RELATIVE TO THE NORTH AMERICAN VERTICAL DATUM (N.A.V.D.) OF 1988 BASED ON A SURVEY PREPARED BY LIDBERG LAND SURVEYING, INC. (561) 746-8454.

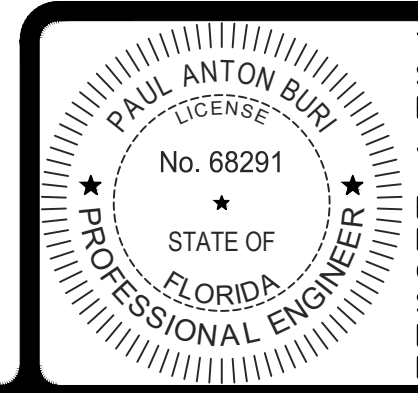

THIS ITEM HAS BEEN DIGITALLY SIGNED AND SEALED BY PAUL ANTON BURI, P.E. ON 3/6/2024.
PRINTED COPIES OF THIS DOCUMENT ARE NOT CONSIDERED SIGNED AND SEALED AND THE SIGNATURE MUST BE VERIFIED ON ANY ELECTRONIC COPIES.

1.) ADDED STATIONING IN ROADWAY PER TOWN OF JUNO BEACH, 3/5/24.



DESIGN P.B.	DRAWN R.W.	CHECKED	APPROVED	DATE
----------------	---------------	---------	----------	------

BID SET

CELESTIAL WAY
SECTION 28, TOWNSHIP 41S., RANGE 43E.
THE TOWN OF JUNO BEACH, FLORIDA
SITE DEVELOPMENT PLAN

JOB NO. 22-004.21	DRAWING NO. 22004.21S04	SHEET 4	OF 8
----------------------	----------------------------	------------	---------

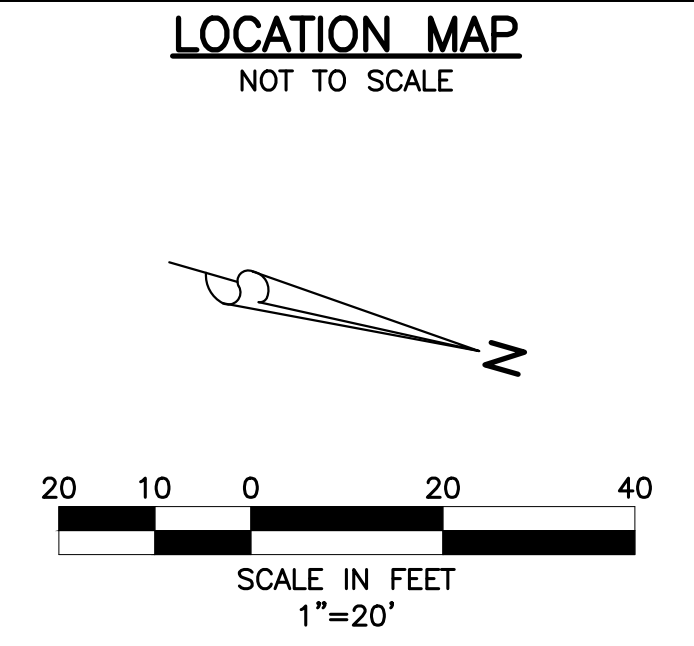
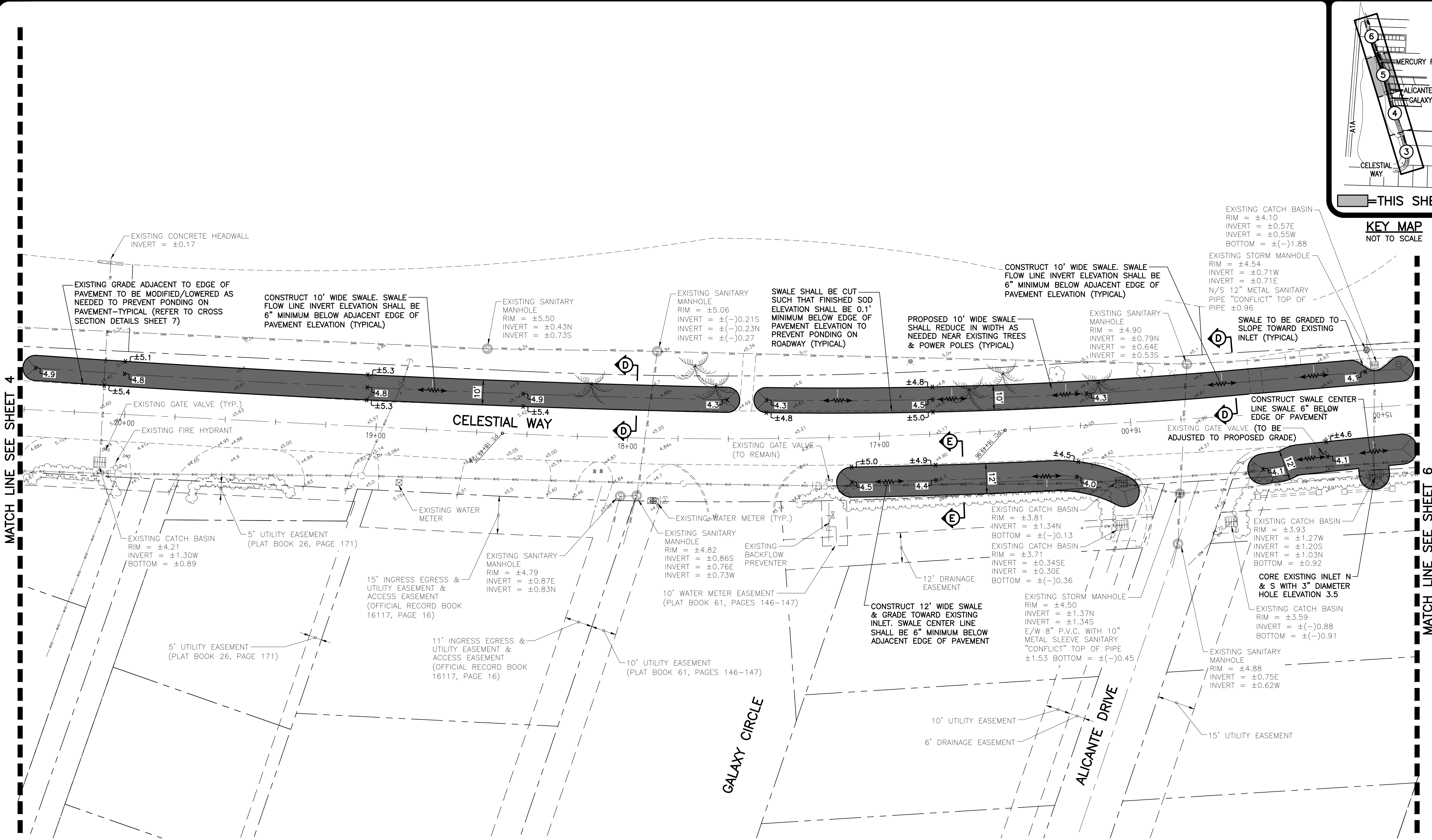
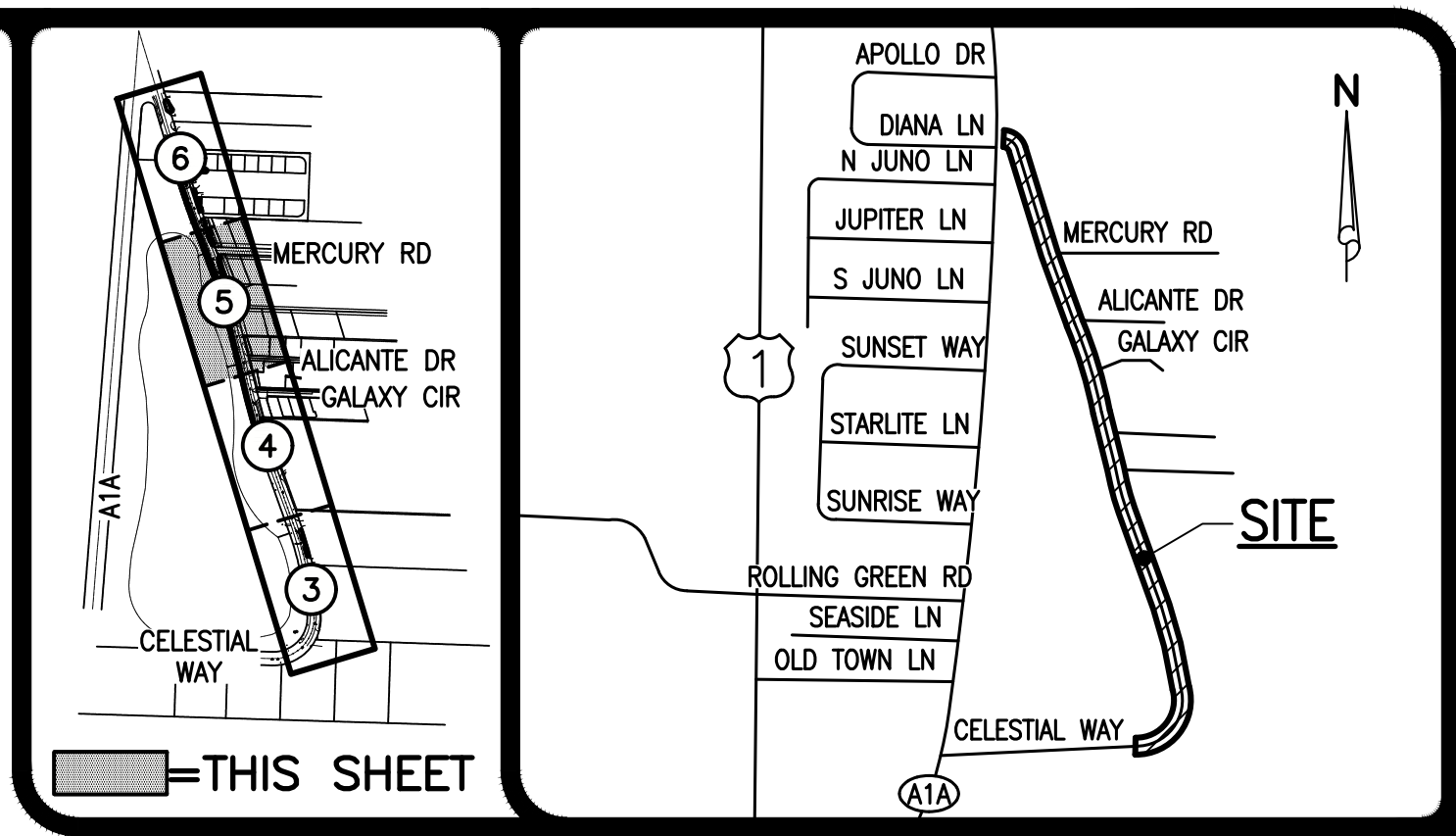

- LEGEND**
- A3-"C" INLET NUMBER AND TYPE
 - 19.5 INLET TOP ELEVATION
 - 16.0 INVERT ELEVATION
 - PROPOSED YARD DRAIN (SEE DETAIL SHEET 7)
 - PROPOSED SWALE
 - PROPOSED GRADE ELEVATION
 - EXISTING GRADE ELEVATION
 - PROPOSED PERVIOUS PAVERS (SEE DETAIL SHEET 7)
 - LIMITS OF SWALE
 - EXISTING OVERHEAD POWER LINE & POWER POLE
 - EXISTING STORM DRAINAGE PIPE
 - EXISTING WATER MAIN
 - EXISTING SEWER MAIN
 - EXISTING FORCE MAIN
- ABBREVIATIONS**
- H.D.P.E. HIGH DENSITY POLYETHYLENE
 - P.V.C. POLYVINYL CHLORIDE PIPE

NOTES:

- CONTRACTOR TO FIELD VERIFY LOCATION AND DEPTH OF ALL EXISTING UTILITIES PRIOR TO CONSTRUCTION AND NOTIFY ENGINEER OF ANY CONFLICTS. IT SHALL BE THE CONTRACTOR'S RESPONSIBILITY TO COORDINATE ALL EXISTING UTILITY LOCATES, SUPPORT, RELOCATIONS AND NOTIFICATIONS REQUIRED WITH ALL APPLICABLE UTILITY SERVICE PROVIDERS.
- SWALE BOTTOM ELEVATION SHALL BE ADJUSTED AS NEEDED TO MAINTAIN 6" MINIMUM DEPTH TO INVERT AS MEASURED FROM ADJACENT E.O.P.. CONTRACTOR SHALL NOTIFY ENGINEER OF ANY CONFLICTS PRIOR TO CONSTRUCTION.
- CONTRACTOR SHALL BE RESPONSIBLE FOR RESTORING ALL ON-SITE & OFF-SITE AREAS DISTURBED DURING CONSTRUCTION TO EXISTING OR BETTER CONDITION.
- CONTRACTOR SHALL BE RESPONSIBLE FOR ALL N.P.D.E.S. REQUIREMENTS INCLUDING FILING OF N.O.I., N.O.T., WEEKLY & MONTHLY MONITORING REPORTS, ETC.
- ALL DRAINAGE STRUCTURES SHALL HAVE 12" MINIMUM SUMP.

48 HOURS BEFORE DIGGING
 BROWARD • PALM BEACH • INDIAN RIVER
 ST. LUCIE • MARTIN COUNTIES
 CALL FOR PERMITS
 1-800-432-4770
 SUNSHINE STATE 1 CALL
 UNDERGROUND UTILITIES
 NOTIFICATION CENTER

NOTE: ALL ELEVATIONS SHOWN HEREON ARE RELATIVE TO THE NORTH AMERICAN VERTICAL DATUM (N.A.V.D.) OF 1988 BASED ON A SURVEY PREPARED BY LIDBERG LAND SURVEYING, INC. (561) 746-8454.

THIS ITEM HAS BEEN DIGITALLY SIGNED AND SEALED BY PAUL ANTON BURI, P.E. ON 3/6/2024.
 PRINTED COPIES OF THIS DOCUMENT ARE NOT CONSIDERED SIGNED AND SEALED AND THE SIGNATURE MUST BE VERIFIED ON ANY ELECTRONIC COPIES.

2.) ADDED STATIONING IN ROADWAY PER TOWN OF JUNO BEACH, 3/5/24.
 1.) MODIFIED MATCH EXISTING PAVEMENT NOTES PER TOWN OF JUNO BEACH, 02/07/24 R.W.

SIMMONS & WHITE
 ENGINEERING | PLANNING | CONSULTING | SINCE 1982
 2581 Metrocentre Blvd West • Suite 3 • West Palm Beach, Florida 33407 • (561) 478-7848

BID SET

CELESTIAL WAY
 SECTION 28, TOWNSHIP 41S., RANGE 43E.
 THE TOWN OF JUNO BEACH, FLORIDA
 SITE DEVELOPMENT PLAN

DESIGN P.B.	DRAWN R.W.	CHECKED	APPROVED	DATE
JOB NO. 22-004.21	DRAWING NO. 22004.21S05	SHEET 5	OF 8	

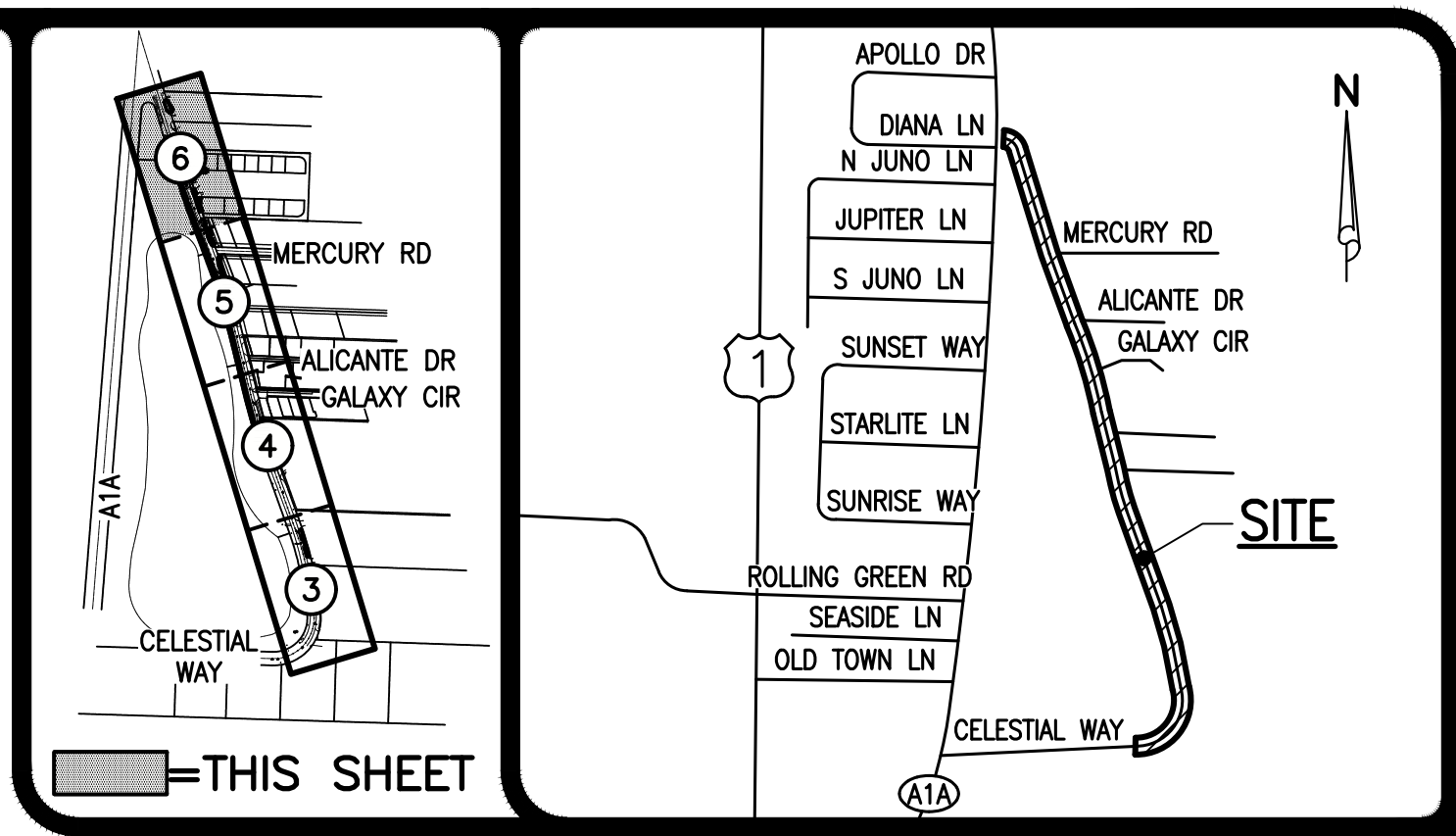

KEY MAP
NOT TO SCALE

LOCATION MAP
NOT TO SCALE

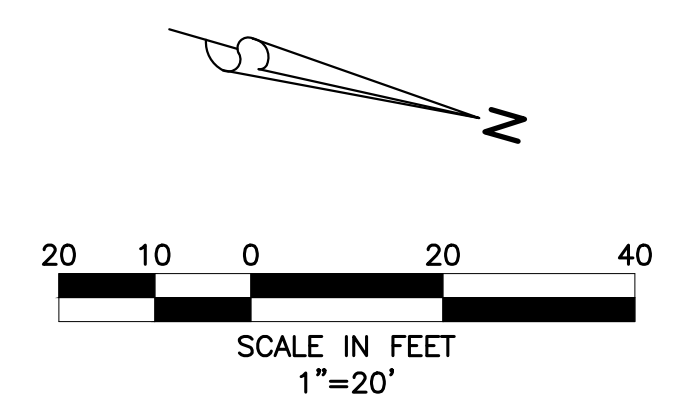

LEGEND

- A3-"C" INLET NUMBER AND TYPE
 - 19.5 INLET TOP ELEVATION
 - 16.0 INVERT ELEVATION
 - PROPOSED YARD DRAIN (SEE DETAIL SHEET 7)
 - PROPOSED SWALE
 - 19.0 PROPOSED GRADE ELEVATION
 - EXISTING GRADE ELEVATION
 - PROPOSED PERVIOUS PAVERS (SEE DETAIL SHEET 7)
 - LIMITS OF SWALE
 - EXISTING OVERHEAD POWER LINE & POWER POLE
 - EXISTING STORM DRAINAGE PIPE
 - EXISTING WATER MAIN
 - EXISTING SEWER MAIN
 - EXISTING FORCE MAIN
- ABBREVIATIONS**
- H.D.P.E. HIGH DENSITY POLYETHYLENE
 - P.V.C. POLYVINYL CHLORIDE PIPE

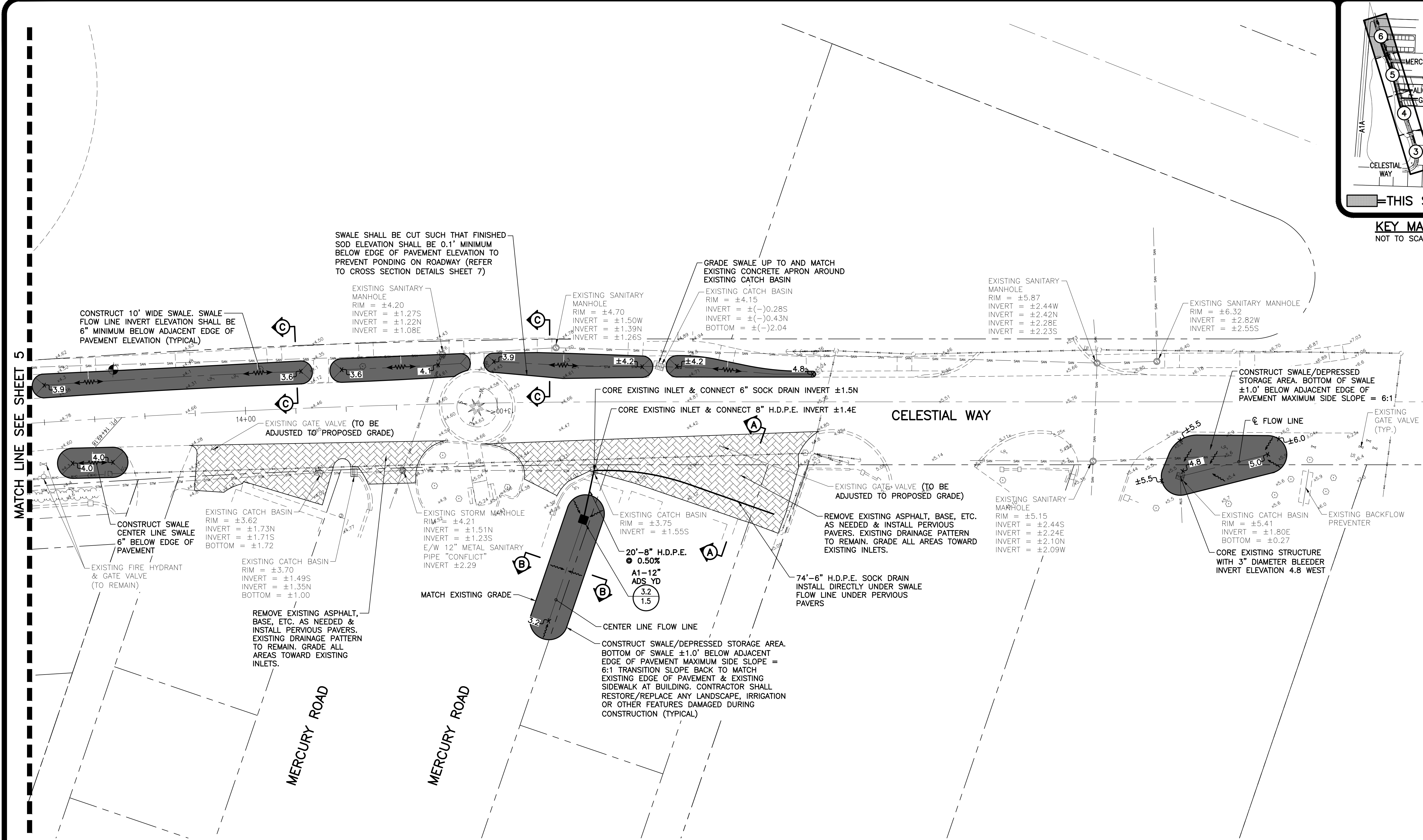

NOTES:

- CONTRACTOR TO FIELD VERIFY LOCATION AND DEPTH OF ALL EXISTING UTILITIES PRIOR TO CONSTRUCTION AND NOTIFY ENGINEER OF ANY CONFLICTS. IT SHALL BE THE CONTRACTOR'S RESPONSIBILITY TO COORDINATE ALL EXISTING UTILITY LOCATES, SUPPORT, RELOCATIONS AND NOTIFICATIONS REQUIRED WITH ALL APPLICABLE UTILITY SERVICE PROVIDERS.
- SWALE BOTTOM ELEVATION SHALL BE ADJUSTED AS NEEDED TO MAINTAIN 6" MINIMUM DEPTH TO INVERT AS MEASURED FROM ADJACENT E.O.P.. CONTRACTOR SHALL NOTIFY ENGINEER OF ANY CONFLICTS PRIOR TO CONSTRUCTION.
- CONTRACTOR SHALL BE RESPONSIBLE FOR RESTORING ALL ON-SITE & OFF-SITE AREAS DISTURBED DURING CONSTRUCTION TO EXISTING OR BETTER CONDITION.
- CONTRACTOR SHALL BE RESPONSIBLE FOR ALL N.P.D.E.S. REQUIREMENTS INCLUDING FILING OF N.O.I., N.O.T., WEEKLY & MONTHLY MONITORING REPORTS, ETC.
- ALL DRAINAGE STRUCTURES SHALL HAVE 12" MINIMUM SUMP.

48 HOURS BEFORE DIGGING
BROWARD • PALM BEACH • INDIAN RIVER
ST. LUCIE • MARTIN COUNTIES
CALL TOLL FREE
1-800-432-4770
SUNSHINE STATE 1 CALL
UNDERGROUND UTILITIES
NOTIFICATION CENTER

NOTE: ALL ELEVATIONS SHOWN HEREON ARE RELATIVE TO THE NORTH AMERICAN VERTICAL DATUM (N.A.V.D.) OF 1988 BASED ON A SURVEY PREPARED BY LIDBERG LAND SURVEYING, INC. (561) 746-8454.

THIS ITEM HAS BEEN DIGITALLY SIGNED AND SEALED BY PAUL ANTON BURI, P.E. ON 3/6/2024.

PRINTED COPIES OF THIS DOCUMENT ARE NOT CONSIDERED SIGNED AND SEALED AND THE SIGNATURE MUST BE VERIFIED ON ANY ELECTRONIC COPIES.

2.) ADDED STATIONING IN ROADWAY PER TOWN OF JUNO BEACH, 3/5/24.
1.) MODIFIED MATCH EXISTING PAVEMENT NOTES PER TOWN OF JUNO BEACH, 02/07/24 R.W.

SIMMONS & WHITE
ENGINEERING | PLANNING | CONSULTING | SINCE 1982
2581 Metrocentre Blvd West • Suite 3 • West Palm Beach, Florida 33407 • (561) 478-7848

DESIGN P.B.	DRAWN R.W.	CHECKED	APPROVED	DATE
----------------	---------------	---------	----------	------

BID SET

CELESTIAL WAY
SECTION 28, TOWNSHIP 41S., RANGE 43E.
THE TOWN OF JUNO BEACH, FLORIDA
SITE DEVELOPMENT PLAN

JOB NO. 22-004.21	DRAWING NO. 22004.21S06	SHEET 6	OF 8
----------------------	----------------------------	------------	---------

GENERAL NOTES:

- NOTIFY ENGINEER OF IN-FIELD CONFLICTS OR DESIGN DISCREPANCIES PRIOR TO COMMENCEMENT OF WORK.
- EXISTING WATER, SEWER AND DRAINAGE SYSTEMS ARE REPRESENTED AS DASHED LINES AND SHALL BE VERIFIED BY CONTRACTOR.
- CONTRACTOR SHALL PROTECT ALL UTILITIES AND PUBLIC IMPROVEMENTS AND SHALL BE RESPONSIBLE FOR ALL DAMAGES CAUSED DURING CONSTRUCTION AND SHALL REPAIR SAID DAMAGES AT HIS EXPENSE. CONTRACTOR TO RESTORE ALL AREAS DISTURBED DURING CONSTRUCTION TO ORIGINAL OR BETTER CONDITION.
- SUPPORT OR THE RELOCATION OF EXISTING STREET LIGHT POLES, POWER OR TELEPHONE POLES, EXISTING UTILITIES, IRRIGATION SYSTEMS, SIDEWALKS, WALLS, ETC. NECESSARY FOR COMPLETION OF THIS WORK ARE THE RESPONSIBILITY OF THE CONTRACTOR AT HIS EXPENSE.
- INFORMATION SHOWN ON THESE DRAWINGS AS TO THE LOCATION OF EXISTING UTILITIES HAS BEEN PREPARED FROM THE MOST RELIABLE DATA AVAILABLE TO THE ENGINEER. THIS INFORMATION IS NOT TO BE GUARANTEED, HOWEVER, AND IT SHALL BE THE CONTRACTOR'S RESPONSIBILITY TO DETERMINE THE LOCATION, CHARACTER AND DEPTH OF ANY EXISTING UTILITIES. ALL "AS-BUILT" INFORMATION INCLUDING LOCATION AND ELEVATION OF UTILITY STUB-OUTS TO BE FIELD VERIFIED BY CONTRACTOR PRIOR TO COMMENCEMENT OF CONSTRUCTION OR ORDERING OF STRUCTURES. NOTIFY ENGINEER OF DISCREPANCIES/CONFLICTS
- THE CONTRACTOR SHALL VERIFY ALL DIMENSIONS NOTIFY THE ENGINEER OF ANY DEVIATIONS PRIOR TO COMMENCING CONSTRUCTION.
- SIDEWALKS TO BE FLUSH WITH YARD AREAS UNLESS OTHERWISE NOTED.
- ALL DRAINAGE CONSTRUCTION SHALL CONFORM TO FLORIDA DEPT. OF TRANSPORTATION STANDARD SPECIFICATIONS FOR ROAD AND BRIDGE CONSTRUCTION (LATEST EDITION) AND THE TOWN OF JUNO BEACH REQUIREMENTS.
- GRADE ALL PAVEMENT AREAS TO CATCH BASINS. CONTRACTOR TO NOTIFY ENGINEER IF IN-FIELD CONDITIONS CHANGE, WILL CREATE CONFLICTS WITH DRAINAGE DESIGN SHOWN, POTENTIAL EROSION PROBLEMS ARISE OR STANDING WATER OCCURS.
- ALL ELEVATIONS SHOWN HEREON REFER TO N.A.V.D. 1988 TOPOGRAPHIC AND BOUNDARY SURVEY PROVIDED BY LIBERG LAND SURVEYING, INC. (561) 746-8454.
- CONTRACTOR SHALL PROVIDE ADEQUATE EQUIPMENT FOR THE REMOVAL OF STORM, SURFACE AND/OR SUBSURFACE WATER WHICH MAY ACCUMULATE IN THE EXCAVATION AREAS SO THAT IT WILL BE SUITABLY DRY FOR WORK REQUIRED.
- NO OFF-SITE DISCHARGE FROM DEWATERING OPERATIONS SHALL BE PERMITTED UNLESS THE CONTRACTOR SECURES WRITTEN PERMISSION FROM THE GOVERNING AUTHORITIES.
- ALL SUB-BASE UNDER ROADWAYS, PARKING LOTS, CURBS, ETC. SHALL BE COMPACTED TO NOT LESS THAN 98% OF MAXIMUM DENSITY AS DETERMINED BY A.A.S.H.T.O. T-180 PROCTOR.
- WHERE ENCOUNTERED (OR SPECIFIED IN THE GEOTECHNICAL REPORT), MUCK/UNSUITABLE MATERIALS SHALL BE COMPLETELY REMOVED FROM PROPOSED PAVING AND BUILDING AREAS 10 FEET BEYOND THE EDGE OF PAVEMENT/BUILDING PAD EACH SIDE.
- CONTRACTOR TO PROVIDE TEST REPORTS FROM AN INDEPENDENT LABORATORY FOR PROCTORS AND DENSITIES ON BASE, SUBGRADE AND PIPE BACKFILL.
- CONTRACTOR IS RESPONSIBLE FOR PROVIDING COMPLETE PAVING AND DRAINAGE, WATER AND SEWER CONSTRUCTION RECORD INFORMATION TO THE ENGINEER.
- CONTRACTOR SHALL ARRANGE FOR THE ENGINEER TO OBSERVE:
 - STORM SEWER AFTER GROUTING AND WHEN BACKFILL IS COMPLETED TO THE MIDPOINT OF THE PIPE.
 - STRINGLINING OF SUBGRADE.
 - STRINGLINING/BOARDING OF BASE.
- THE CONTRACTOR SHALL FILL AND FINE GRADE ALL PLANTING AREAS, LEAVING THE FINISHED GRADE SMOOTH AND READY TO RECEIVE SOD OR OTHER PLANTING MATERIAL. WHERE SOD IS DESIRED, THE FINISHED GRADES SHALL BE TWO (2) INCHES LOWER TO ALLOW FOR THICKNESS OF THE GRASS. SPECIAL ATTENTION SHALL BE GIVEN ALONG EDGE OF PAVEMENT AND SIDEWALKS SO AS NOT TO TRAP WATER.
- ANY SHELLROCK OR LIMEROCK PAVING BASE INSTALLED WITHIN PLANTING AREAS SHALL BE REMOVED IN ITS ENTIRETY PRIOR TO PLACING PLANTER AREA FILL.
- ALL SWALE, RIGHT OF WAY AREAS AND YARD AREAS SHALL BE GRADED AND SEEDED OR SODDED IN ACCORDANCE WITH GOVERNING AGENCY STANDARDS. NO AREAS SHALL BE LEFT BARREN OR SUBJECT TO EROSION.
- IT SHALL BE THE CONTRACTOR'S RESPONSIBILITY TO ADHERE TO ALL O.S.H.A. RULES AND FLORIDA LAWS RELATED TO TRENCH SAFETY.
- CONTRACTOR SHALL ENSURE NO SEDIMENT OR DEBRIS LEAVES THE SITE DURING CONSTRUCTION IN ACCORDANCE WITH N.P.D.E.S. REQUIREMENTS (SILT FENCE, HAY BALES OR SOD APRONS AT INLETS, WASH ROCK EXIT, ETC. MAY BE REQUIRED TO MEET SAID REQUIREMENTS). CONTRACTOR SHALL BE RESPONSIBLE FOR THE PREPARATION, IMPLEMENTATION AND CERTIFICATION OF ALL N.P.D.E.S. POLLUTION PREVENTION RELATED MEASURES (i.e. FILING OF AN N.O.I. POLLUTION PREVENTION PLAN MONITORING REPORTS, ETC.)

DENSITY TESTING REQUIREMENTS:

- PIPE TRENCHES SHALL BE TESTED AT RANDOMLY SELECTED LOCATIONS ALONG THE LENGTH OF EACH PIPE RUN WITHIN EACH 300' INTERVAL (MAXIMUM) AND BETWEEN EACH SET OF TWO STRUCTURES IF A PIPE RUN SEPARATING THE TWO IS LESS THAN 300' IN LENGTH.
 - ALL PIPE AND STRUCTURE TRENCHES SHALL BE BACKFILLED USING A MAX. OF 12" LIFTS. ALL BACKFILL MATERIAL SHALL BE CLEAN, DRY STRUCTURAL FILL, WITH NO DELETERIOUS OR ORGANIC MATERIAL PRESENT.
 - AT LEAST ONE TEST SHALL BE PERFORMED FOR EVERY 12" OF DEPTH, STARTING AT THE SPRINGLINE OF THE PIPE, COVERING THE 12" LAYER BELOW THE SPRINGLINE OF THE PIPE.
 - TESTS SHALL BE PERFORMED AT EVERY STRUCTURE BEGINNING AT THE BASE OF THE STRUCTURE (COVERING THE 12" BELOW THE BASE OF THE STRUCTURE) WITH ONE TEST FOR EVERY 12" LIFT. TESTS SHALL ALTERNATE FROM CORNER TO CORNER OR FROM SIDE TO SIDE AROUND THE STRUCTURE WITH EACH 12" LIFT.
 - ALL DENSITY TESTS SHALL BE SIGNED AND SEALED BY A REGISTERED PROFESSIONAL GEOTECHNICAL ENGINEER, LICENSED IN THE STATE OF FLORIDA.
- NOTE: ALL TESTS AND LOCATIONS ARE SUBJECT TO REVIEW BY REPRESENTATIVES OF OUR OFFICE AND ADDITIONAL TESTS MAY BE REQUIRED BASED ON FIELD OBSERVATIONS OF CONSTRUCTION TECHNIQUES OR MATERIALS USED ON SITE.

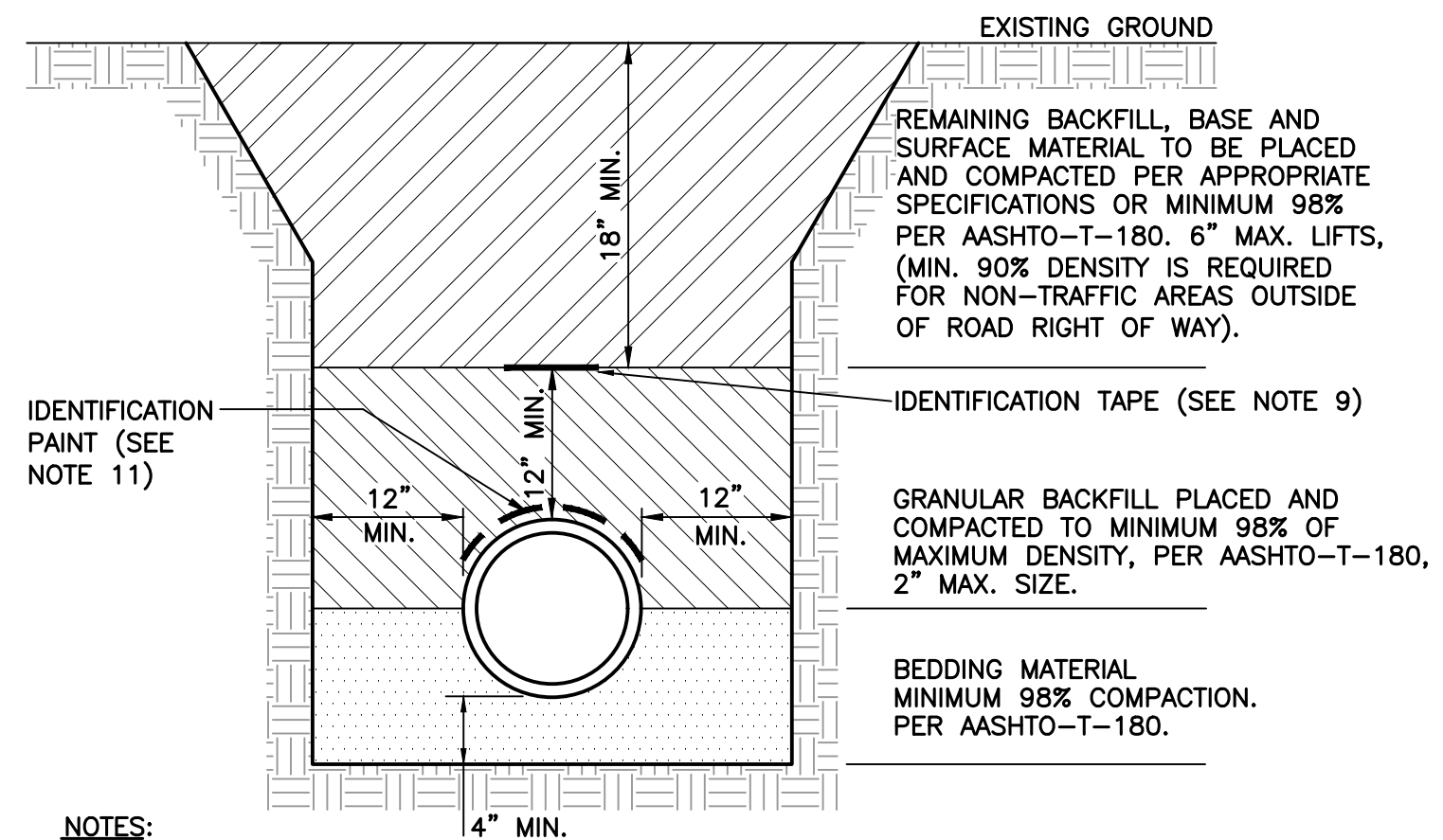

NOTES:

- BEDDING SHALL CONSIST OF IN-SITU GRANULAR MATERIAL OR WASHED AND GRADED LIMEROCK 3/8" - 7/8" SIZING WITH EQUAL OR GREATER STRUCTURAL ADEQUACY AS EXISTING. UNSUITABLE IN-SITU MATERIALS SUCH AS MUCK, DEBRIS AND LARGER ROCKS SHALL BE REMOVED.
- THE PIPE SHALL BE FULLY SUPPORTED FOR ITS ENTIRE LENGTH WITH APPROPRIATE COMPACTION UNDER THE PIPE HAUNCHES.
- THE PIPE SHALL BE PLACED IN A DRY TRENCH.
- BACKFILL SHALL BE FREE OF UNSUITABLE MATERIAL SUCH AS LARGE ROCK, MUCK AND DEBRIS.
- DENSITY TESTS ARE TAKEN IN 1 FOOT LIFTS ABOVE THE PIPE AT INTERVALS OF 400' MAXIMUM, (MINIMUM 1 SET) OR AS DIRECTED BY THE CONSTRUCTION COORDINATION DIVISION. RESULTS SHALL BE SUBMITTED TO CONSTRUCTION COORDINATION AS PART OF THEIR FIELD REVIEW.
- THE PERMITTEE/DEVELOPER/CONTRACTOR SHALL BE RESPONSIBLE TO COMPLY WITH ALL TRENCH SAFETY LAWS AND REGULATIONS.
- SEE SEPARATE DETAIL FOR PAVED AREAS (OPEN CUT FOR THOROUGHFARE AND NON-THOROUGHFARE ROADS).
- THE AFFECTED AREA SHALL BE RESTORED TO EQUAL OR BETTER CONDITION OR AS SPECIFIED IN PERMIT/CONTRACT DOCUMENTS.
- APPROVED MAGNETIC TAPE IS REQUIRED FOR ALL MAIN PRESSURE PIPES AND CONDUIT IN THE ROAD RIGHT-OF-WAY. INSTALL TAPE 18" BELOW FINISHED GRADE.
- ROOT BARRIER IS REQUIRED FOR APPROVED PIPE INSTALLATION CLOSER THAN 10 FEET FROM AN EXISTING TREE. SEE ROOT BARRIER DETAIL FROM TOWN OF JUNO UTILITIES.
- CONTINUOUS 4" WIDE PAINT STRIPING IS REQUIRED FOR DIP/PCCP WATER MAINS (BLUE), DIP SANITARY FORCE MAINS (GREEN), DIP RECLAIMED WATER MAINS (PURPLE), GAS MAINS (YELLOW), OR AS REQUIRED BY THE APWA.
- PERMANENT ABOVE GROUND UTILITY MARKER SHALL BE INSTALLED IF REQUIRED.

TYPICAL TRENCH DETAIL (NON-PAVED AREAS)

NOT TO SCALE

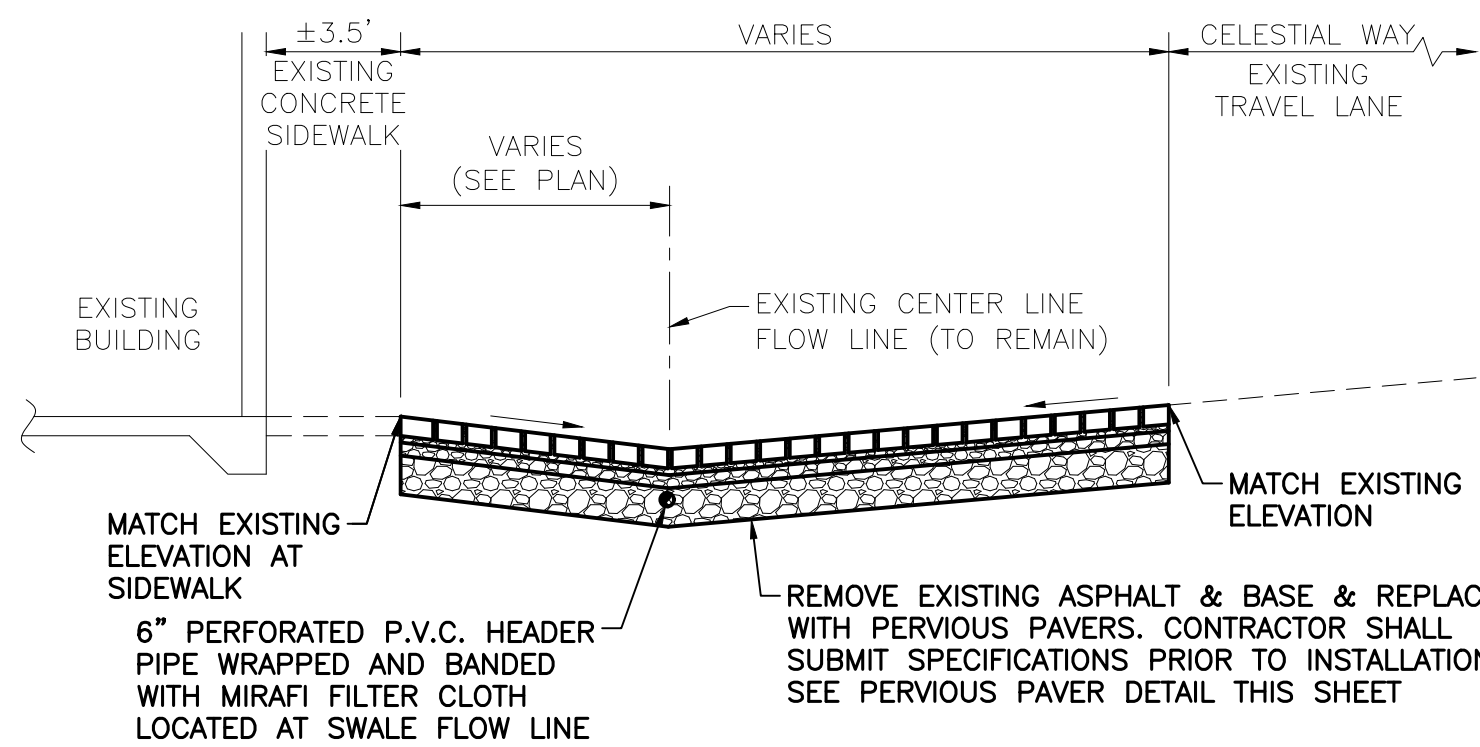

TYPICAL SECTION A-A

NOT TO SCALE

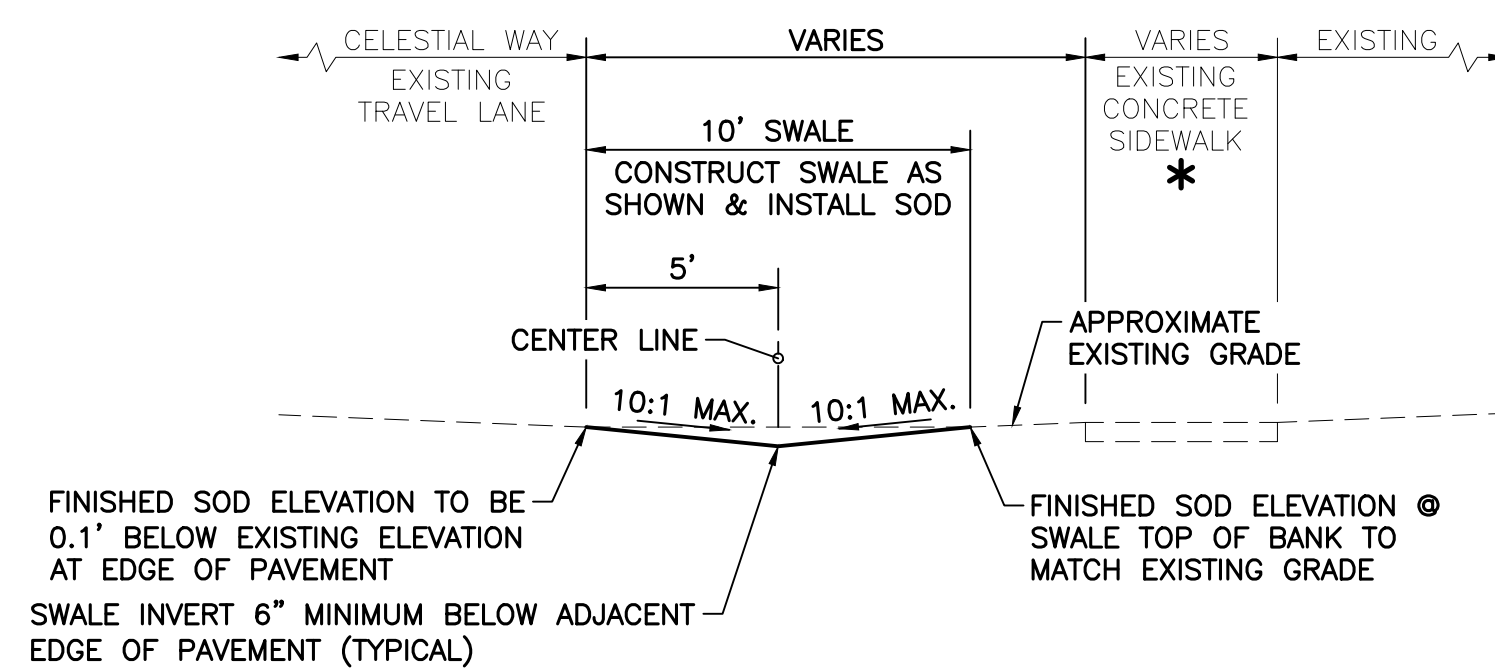

TYPICAL SECTION D-D

NOT TO SCALE

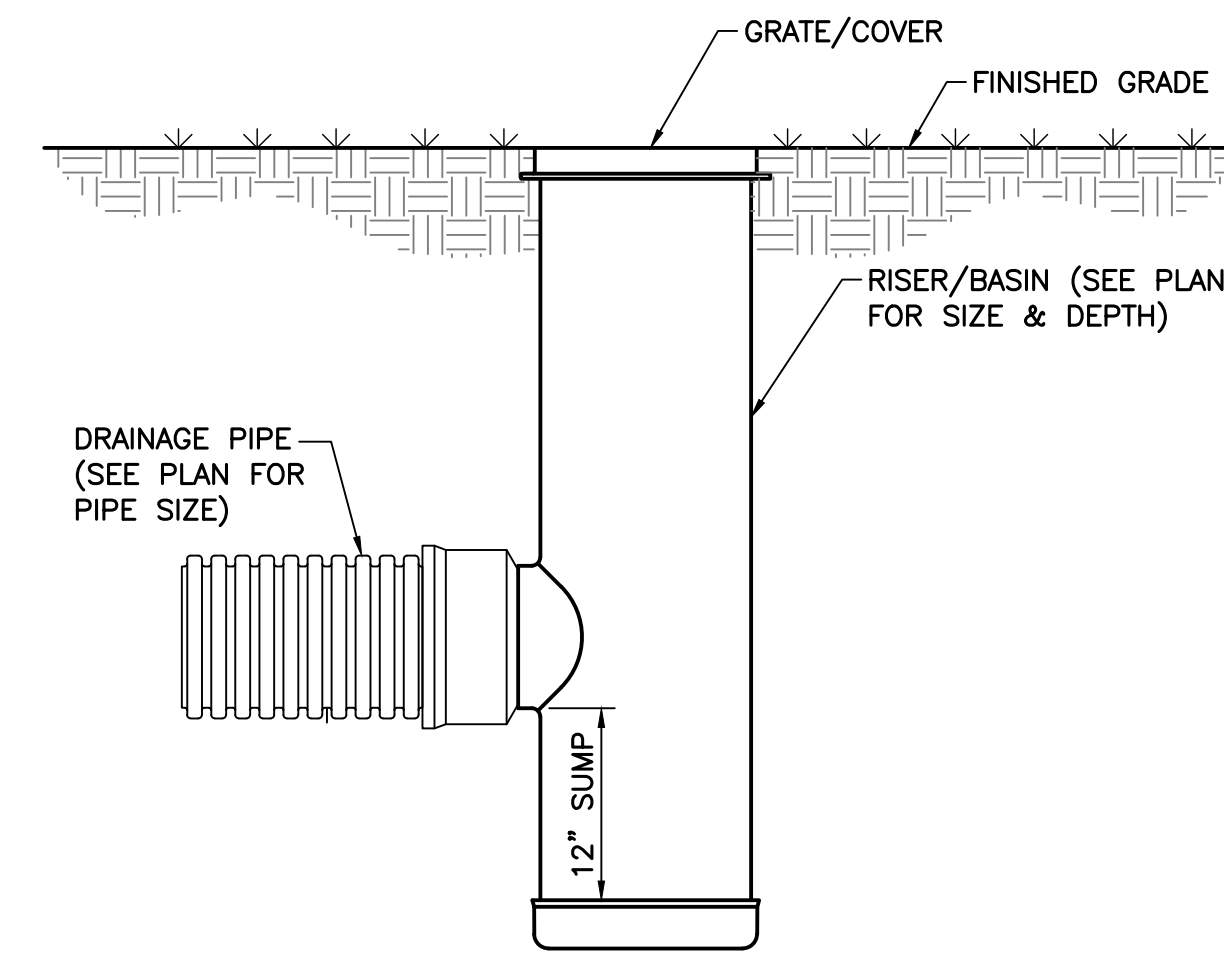

YARD DRAIN DETAIL

NOT TO SCALE

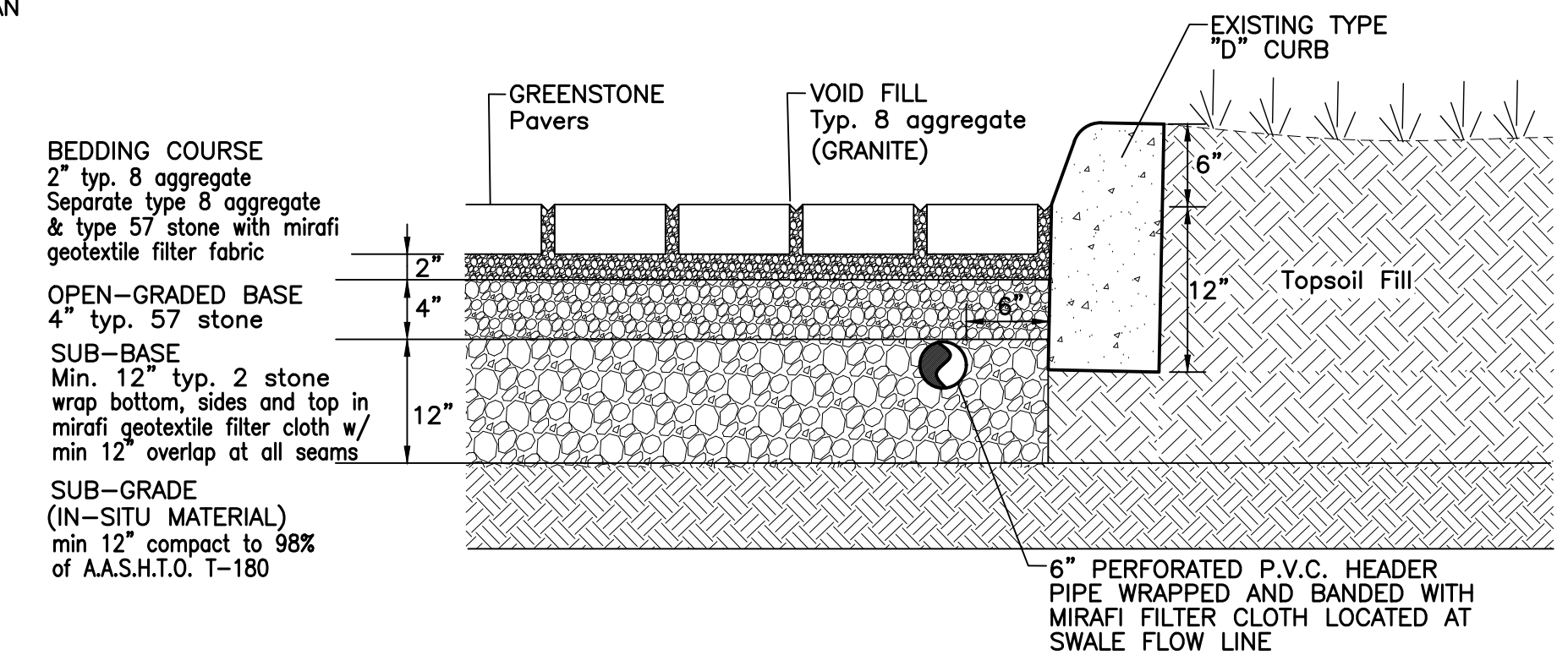

PERVIOUS PAVER DETAIL

NOT TO SCALE

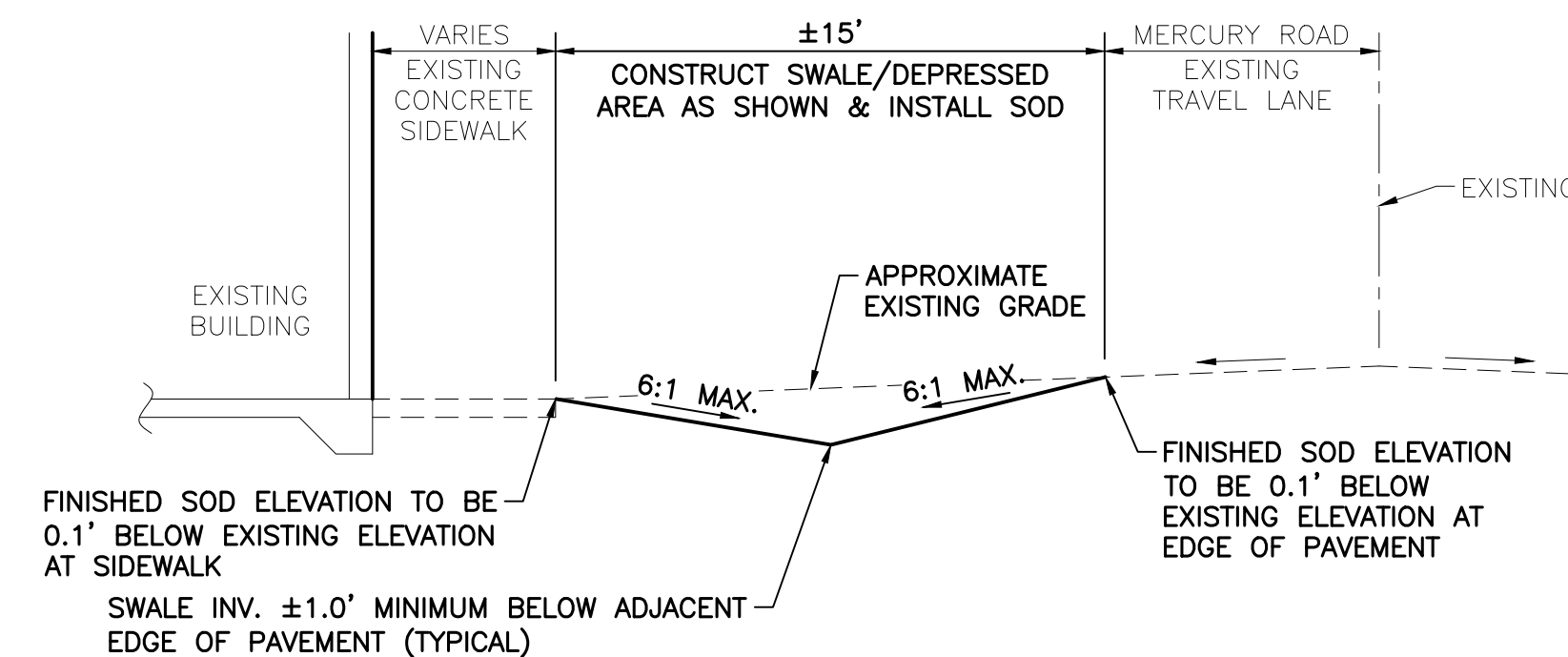

TYPICAL SECTION B-B

NOT TO SCALE

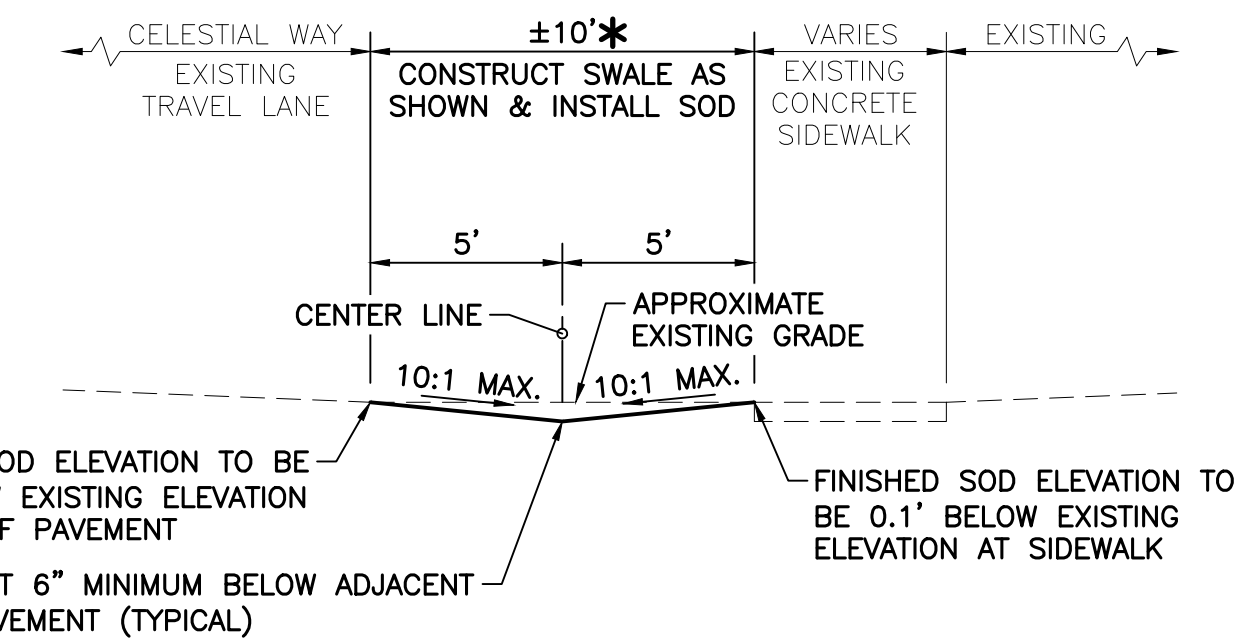

TYPICAL SECTION C-C

NOT TO SCALE

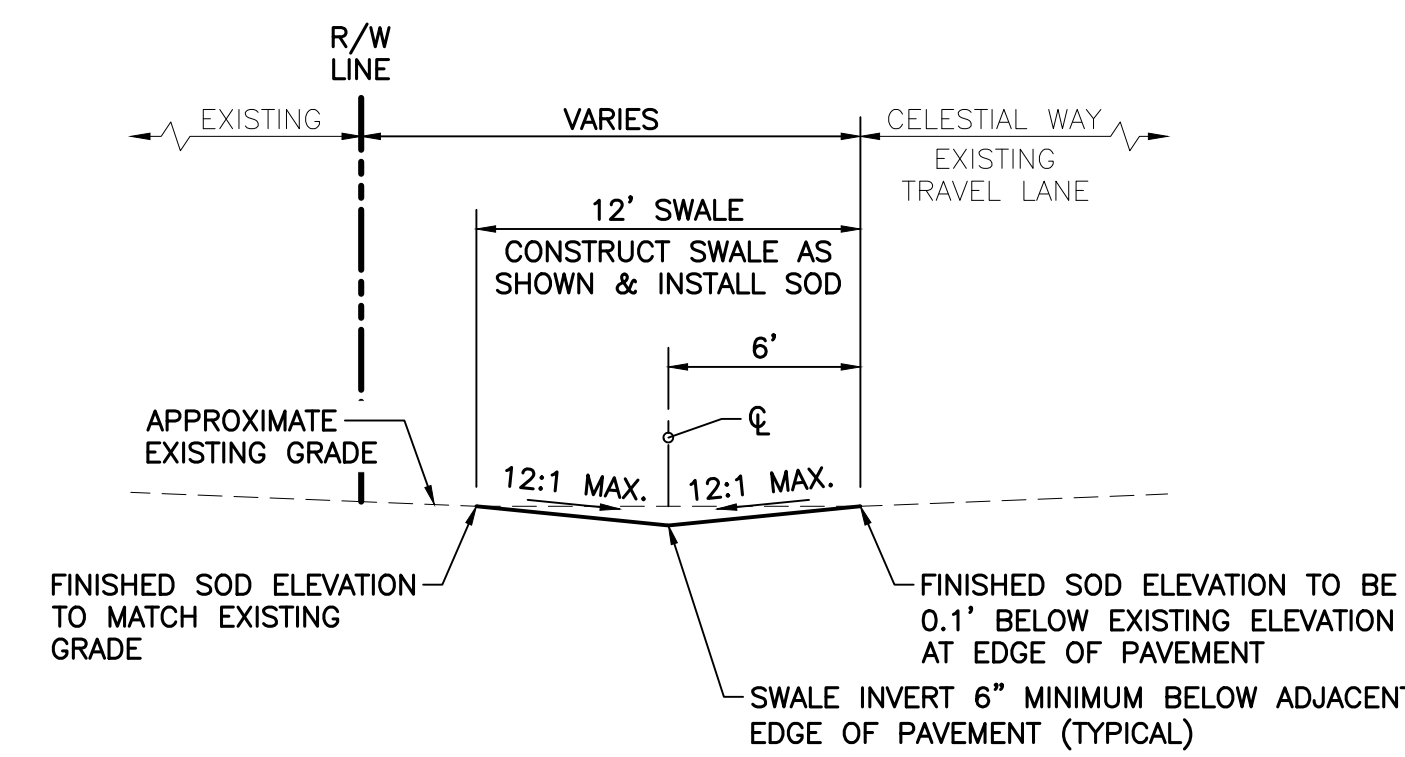

TYPICAL SECTION E-E

NOT TO SCALE

THIS ITEM HAS BEEN DIGITALLY SIGNED AND SEALED BY PAUL ANTON BURI, P.E. ON 3/6/2024.

PRINTED COPIES OF THIS DOCUMENT ARE NOT CONSIDERED SIGNED AND SEALED AND THE SIGNATURE MUST BE VERIFIED ON ANY ELECTRONIC COPIES.

1.) REVISED TYPICAL TRENCH DETAIL PER TOWN OF JUNO BEACH COMMENTS, 02/07/24 R.W.

DESIGN	DRAWN	CHECKED	APPROVED	DATE
P.B.	R.W.			

BID SET

CELESTIAL WAY
SECTION 28, TOWNSHIP 41S., RANGE 43E.
THE TOWN OF JUNO BEACH, FLORIDA
SITE DEVELOPMENT DETAILS

JOB NO.	DRAWING NO.	SHEET	OF
22-004.21	22004.21S07	7	8

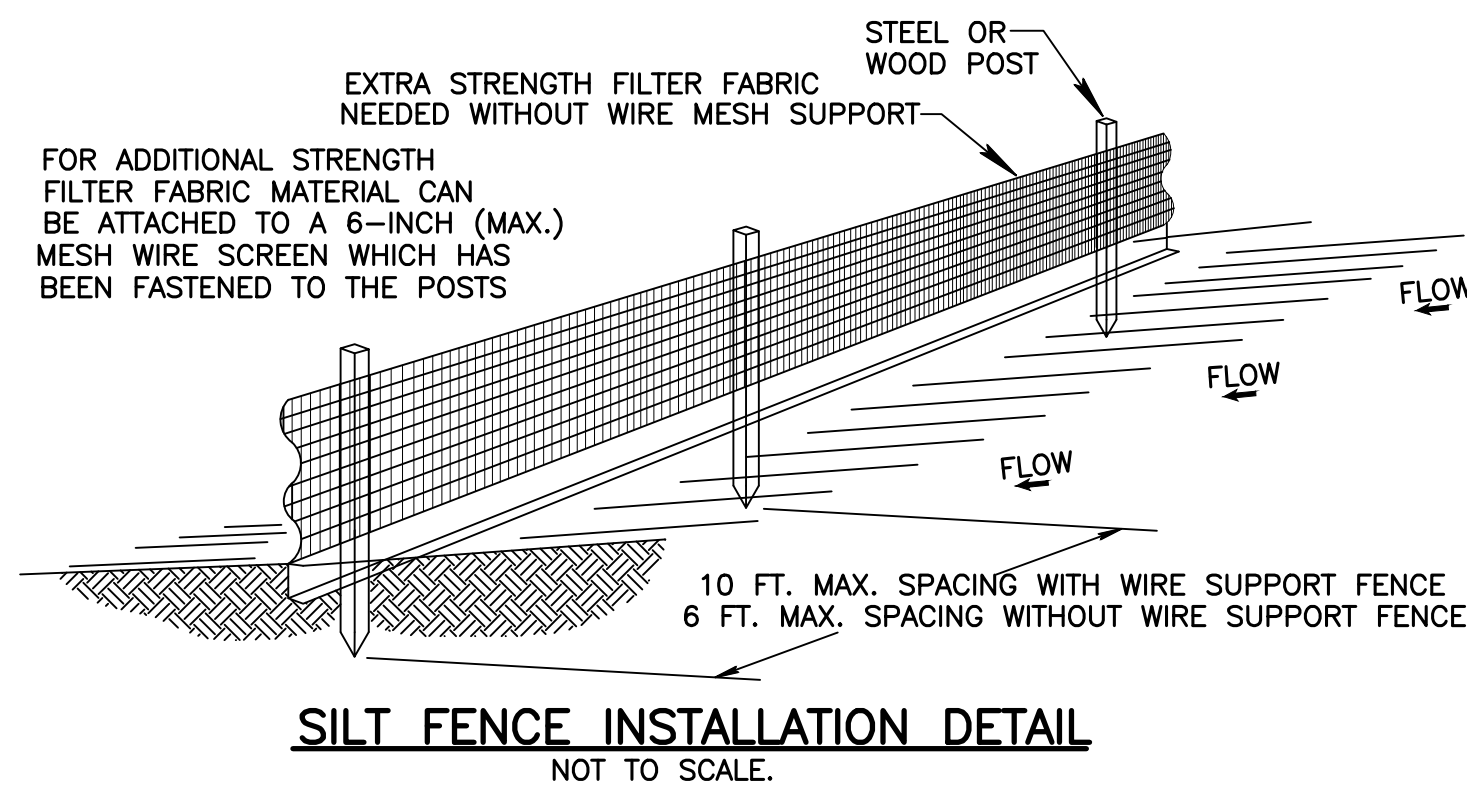

SILT FENCE NOTES:

- 1.) THE HEIGHT OF A SILT FENCE SHALL NOT EXCEED 36 INCHES (90 CM).
- 2.) THE FILTER FABRIC SHALL BE PURCHASED IN A CONTINUOUS ROLL CUT TO THE LENGTH OF THE BARRIER TO AVOID THE USE OF JOINTS.
- 3.) POSTS SHALL BE SPACED A MAXIMUM OF 10 FEET (3 M) APART AT THE BARRIER LOCATION AND DRIVEN SECURELY INTO THE GROUND A MINIMUM OF 12 INCHES (30 CM). WHEN EXTRA STRENGTH FABRIC IS USED WITHOUT THE WIRE SUPPORT FENCE, POST SPACING SHALL NOT EXCEED 6 FEET (1.8 M).
- 4.) A TRENCH SHALL BE EXCAVATED APPROXIMATELY 4 INCHES (10 CM) WIDE AND 4 INCHES (10 CM) DEEP ALONG THE LINE OF POSTS AND UPSLOPE FROM THE BARRIER.
- 5.) WHEN STANDARD STRENGTH FILTER FABRIC IS USED. A WIRE MESH SUPPORT FENCE SHALL BE FASTENED SECURELY TO THE UPSLOPE SIDE OF THE POSTS USING HEAVY DUTY WIRE STAPLES AT LEAST 1 INCH (25 MM) LONG, TIE WIRES, OR HOG RINGS. THE WIRE SHALL EXTEND INTO THE TRENCH A MINIMUM OF 2 INCHES (5 CM) AND SHALL NOT EXTEND MORE THAN 36 INCHES (90 CM) ABOVE THE ORIGINAL GROUND SURFACE.
- 6.) THE STANDARD STRENGTH FILTER FABRIC SHALL BE STAPLED OR WIRED TO THE FENCE, AND 8 INCHES (20 CM) OF THE FABRIC SHALL BE EXTENDED INTO THE TRENCH. THE FABRIC SHALL NOT EXTEND MORE THAN 36 INCHES (90 CM) ABOVE THE ORIGINAL GROUND SURFACE.
- 7.) THE TRENCH SHALL BE BACKFILLED AND THE SOIL COMPACTED OVER THE FILTER FABRIC.
- 8.) PROPOSED SILT FENCE (REQUIRED DURING CONSTRUCTION PER N.P.D.E.S./F.D.E.P. REGULATIONS) TO BE PLACED AS NECESSARY BY CONTRACTOR BASED ON FIELD CONDITIONS AND CONSTRUCTION SEQUENCING.

POLLUTION PREVENTION NOTES:

- 1.) THIS PLAN SHOULD BE USED AS A GUIDE. A COMPLETE STORMWATER POLLUTION PLAN SHOULD BE DEVELOPED BY THE CONTRACTOR TO MEET OR EXCEED F.D.E.P. REQUIREMENTS.
- 2.) CONTRACTOR IS RESPONSIBLE TO ENSURE THAT NO DIRT BE TRACKED OFF-SITE OR LEAVES THE SITE BY WIND, RUNOFF, OR OTHER MEANS.
- 3.) CONTRACTOR SHALL BE RESPONSIBLE FOR ALL N.P.D.E.S. REQUIREMENTS INCLUDING FILING OF N.O.I., MONITORING REPORTS AND N.O.T.
- 4.) POLLUTION PREVENTION MEASURES SHALL CONSIST OF, BUT NOT LIMITED TO, THE FOLLOWING:
 - A. CONSTRUCT WASHROCK PAD AT ALL POINTS EGRESS FOR WASHDOWN OF TRUCK TIRES.
 - B. CONSTRUCT EROSION CONTROL FENCE AND/OR TURBIDITY SCREENS ALONG PROPERTY LINES AS NEEDED.
 - C. NO AREA SHALL BE LEFT BARREN OR SUBJECT TO EROSION DURING CONSTRUCTION. SEEDING AND MULCHING IS REQUIRED FOR ANY AREAS ANTICIPATED TO BE BARREN DURING CONSTRUCTION FOR MORE THAN 15 DAYS.
 - D. TURBIDITY BARRIERS TO BE UTILIZED AT PROJECT OUTFALL.
 - E. OTHER MEASURES AS DIRECTED BY THE ENGINEER OR THE TOWN OF JUNO BEACH.
- 5.) IT IS THE CONTRACTORS RESPONSIBILITY TO COMPLY WITH ALL LOCAL, STATE AND FEDERAL POLLUTION PREVENTION REQUIREMENTS. FOR AFFECTED AREAS GREATER THAN 1 ACRE, COMPLIANCE SHALL INCLUDE (BUT IS NOT LIMITED TO) THE FOLLOWING:
 - A. PREPARATION OF A STORMWATER POLLUTION PREVENTION PLAN (S.W.P.P.) IN ACCORDANCE WITH THE D.E.P. "GENERIC PERMIT FOR STORMWATER DISCHARGE FROM LARGE AND SMALL CONSTRUCTION ACTIVITIES" (D.E.P. DOCUMENT NO. 62-621.300(4)(A))
 - B. SUBMITTAL OF THE NOTICE OF INTENT (N.O.I.) TO THE D.E.P.
 - C. MAINTENANCE AND INSPECTION OF THE ELEMENTS OF THE S.W.P.P.
 - D. MAINTENANCE OF RECORDS (INSPECTION REPORTS, N.O.I., S.W.P.P., ETC.)
 - E. SUBMITTAL OF THE NOTICE OF TERMINATION TO THE D.E.P. AT THE CONCLUSION OF THE PROJECT.
- 6.) PROPOSED SILT FENCE (REQUIRED DURING CONSTRUCTION PER N.P.D.E.S./F.D.E.P. REGULATIONS) TO BE PLACED AS NECESSARY BY CONTRACTOR BASED ON FIELD CONDITIONS & CONSTRUCTION SEQUENCING.

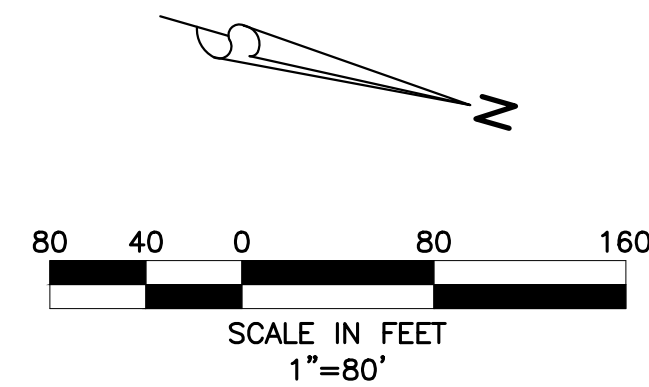
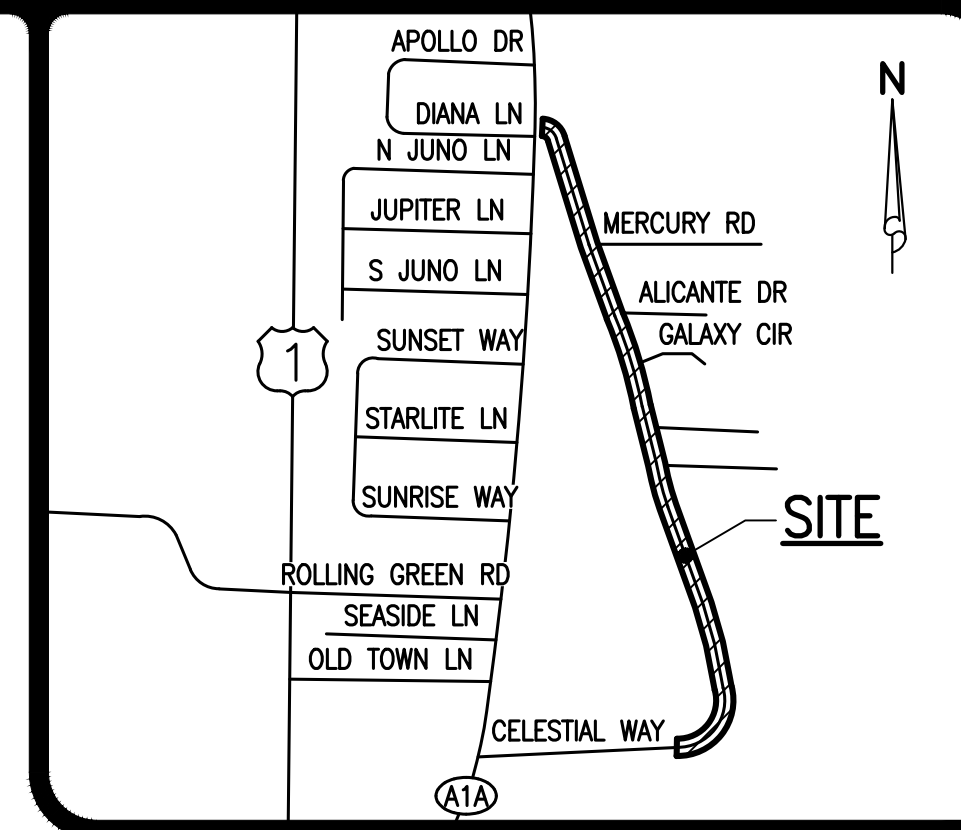

LEGEND

- SILT FENCE
- INLET PROTECTION AROUND EXISTING CATCH BASIN



BID SET

48 HOURS BEFORE DIGGING
BROWARD • PALM BEACH • INDIAN RIVER
ST. LUCIE • MARTIN COUNTIES
CALL FOR PERMITS
1-800-432-4770
SUNSHINE STATE 1 CALL
UNDERGROUND UTILITIES
NOTIFICATION CENTER

NOTE: ALL ELEVATIONS SHOWN HEREON ARE RELATIVE TO THE NORTH AMERICAN VERTICAL DATUM (N.A.V.D.) OF 1988 BASED ON A SURVEY PREPARED BY LIDBERG LAND SURVEYING, INC. (561) 746-8454.

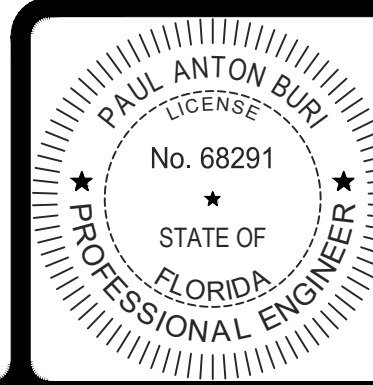

THIS ITEM HAS BEEN DIGITALLY SIGNED AND SEALED BY PAUL ANTON BURI, P.E. ON 3/6/2024.
PRINTED COPIES OF THIS DOCUMENT ARE NOT CONSIDERED SIGNED AND SEALED AND THE SIGNATURE MUST BE VERIFIED ON ANY ELECTRONIC COPIES.



CELESTIAL WAY
SECTION 28, TOWNSHIP 41S., RANGE 43E.
THE TOWN OF JUNO BEACH, FLORIDA
POLLUTION PREVENTION PLAN

REVISIONS

DESIGN	DRAWN	CHECKED	APPROVED	DATE
P.B.	R.W.			

JOB NO.	DRAWING NO.	SHEET	OF
22-004.21	22004.21S08	8	8